

MAP: F8-9  
 CKT: D23950-1  
 (WILKINSBURG)

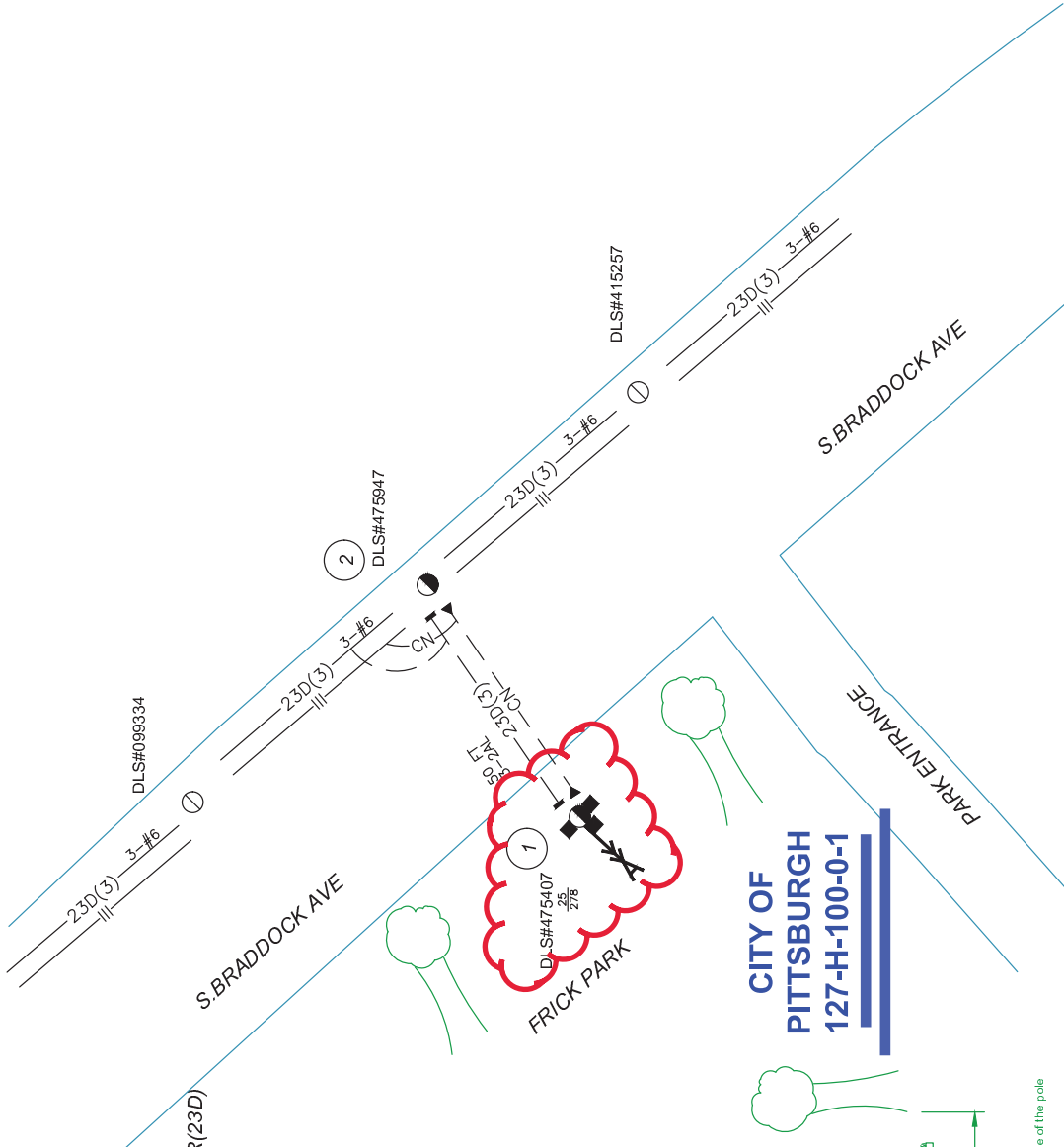

DESIGN PA I-CALL  
 1. 2024222741  
 2. 2024222781

THIRD PARTY TRANSFERS  
 NJLINS TK # 6531861  
 1. COMCAST  
 2. VERIZON

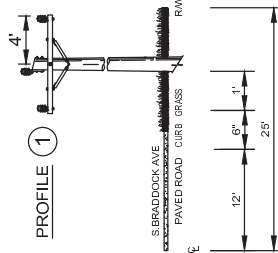

- 1  
 DLS475407  
 50' CL2 POLE  
 23D-8'DXD  
 (OH-7-20A)  
 3(277/480V CSP XFMR(23D)  
 25 KVA(OH-10-82)  
 CN BKT  
 2-10M A.G(23D)  
 DBL HELIX
- 2  
 DLS475947  
 50' CL2 POLE  
 23D-8'SXA  
 (OH-7-27C)  
 9'DXDD-3P TAP(23D)  
 25 KVA(OH-10-82)  
 CN BKT  
 358 BKT

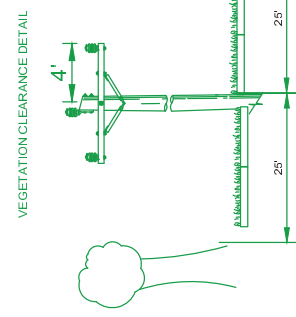

25' Ground to sky vegetation clearance from the centerline of the pole

		SERVICE AND METER FOR PARK LIGHTING 715 S. BRADDOCK AVE, PGH (WARD#14) 277/480V SERVICE FOR LIGHTING	
AS-ISSUED CHD	AS-MARK CHD	DATE	DATE
		8/28/24	
DATE	DRAWN BY	DATE	DATE
	K. Motilji		
	DRAFT CHC.	DATE	DATE
	*	*	*
SCALE	IPPN. NO.	DWG. NO.	REV.
B N.T.S	20-0005	986958	0

REVISIONS