

WILLIAM PEDUTO
MAYOR



KIMBERLY LUCAS
ACTING DIRECTOR

November , 2021

President and Members
City Council
City of Pittsburgh

**RE: 4632 CENTRE AVE
ENCROACHMENT**

Dear President and Members of City Council:

We have a request for an encroachment permit at 4632 Centre Ave, in the 4th Ward, 8th Council District, as shown on the attached plan. A copy of the request is also attached.

ERTUGRUL & NESLIHAN KILIC, is proposing to reconstruct 3 existing sets of entrance steps, and to install (4) new (3' x 10') tree pits, and a new (4' x 8') awning. The steps are proposed to be rebuilt in the same configuration as the existing steps.

Your favorable approval of this proposed Resolution is hereby recommended.

Sincerely,

Kimberly Lucas

Kimberly Lucas
Acting Director

KL:JM
Attachments

WILLIAM PEDUTO
MAYOR



KIM LUCAS
ACTING DIRECTOR

CITY OF PITTSBURGH
DEPARTMENT OF MOBILITY & INFRASTRUCTURE
CITY-COUNTY BUILDING

Application for an Encroachment on City Dedicated Right-Of-Way

Date: 11/04/21

Applicant Name: Nathan Hart, R.A.

Property Owner's Name (if different from Applicant): Ertugrul Kilic

Address: 4632 Centre Ave

Phone Number: 412-214-7550 Alternate Phone Number: 412-670-5677

Location of Proposed Encroachment: sidewalks adj to Centre and Melwood Ave

Ward: 4 Council District: _____ Lot and Block: 027-D-241

What is the properties zoning district code: OPR-B (zoning office 255-2241)

Planning/Zoning Case OneStop Number (if applicable): ZDR- _____

Is the existing right-of-way, a street or a sidewalk? Yes

Width of Existing Right-of-Way (sidewalk or street): 10'-0" (Before encroachment)

Length of Existing Right-of-Way (sidewalk or street): 105'-0" (Before encroachment)

Width of Proposed Encroachment: Street Trees: 3'-0". Awning: 4'-0". Steps: 5' max.

Length of Proposed Encroachment: Street Trees: 10'-0". Awning: 8'-0", Steps: 12' max.

Number of feet the proposed object will encroach into the ROW: Street Trees: 3'-0". Awning: 4'-0"

Description of encroachment: (4) new street tree pits, (2) bike racks, (1) 4' x 8' building mounted awning, 3 sets of steps to building.

Reason for application:

Zoning requirements for street trees and bike racks. Awning to provide shelter for steps.
Three sets of steps to existing building entrances.

DOMI
City County Bldg
Pittsburgh, PA

ATTN: Karina Ricks

RE: 4632 Centre Ave

Ms. Ricks,

We have filed DOMI Encroachment Plan DOMI-EN-2021-14041 for exterior work in the public sidewalk including the following:

- Four new street trees facing Melwood Ave
- Two 'U' style bike racks facing Melwood Ave.
- Three existing concrete stairs to existing entrance doors to the building. The two facing Centre Ave are proposed to be rebuilt in the same configuration as the existing steps.
- One canvas canopy over the doors on the Melwood Ave side of the building.

Plans are uploaded to the application file in Onestop for your reference. Should you or your staff require any additional information, please feel contact my office.

Thank you,

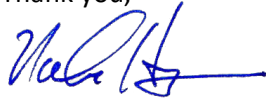
A handwritten signature in blue ink, appearing to read "Nathan Hart", with a long horizontal flourish extending to the right.

Nathan Hart, R.A.



984 Greenfield Ave
Pittsburgh, PA 15217
www.hartarc.com

© Hart Architectural Services, LLC

Item to be Inspected	Inspection Frequency	Observation	Maintenance/Repair	Required Equipment	Manhours/Maint. or Repair	Cost/Maint. or Repair	Responsible Party
(4) trees in new tree pits	Weekly when work commences	Architect	New Build	n/a	2 hrs/month (maintenance)	Est. \$1800	Owner
(2) sidewalk bike racks	After installation	Architect	New Build	Drill	4 hours (new build)	Est. \$1500	Owner
Dumpster pad, screen & gate	Weekly when work commences	Architect	New Build	Concrete truck	24 hours (new build)	Est. \$8,000	Owner

PROJECT DIRECTORY

Owner
Ertugrul Kilic
4635 Centre Avenue
Pittsburgh, PA 15217
Phone: 412-760-5677
Email: ertugrukilic75@hotmail.com

Architect
Hart Architectural Services, LLC
Nathan Hart, R.A.
603 Greenfield Avenue
Pittsburgh, PA 15207
Phone: 412-214-7550
Email: nhart@hartarc.com

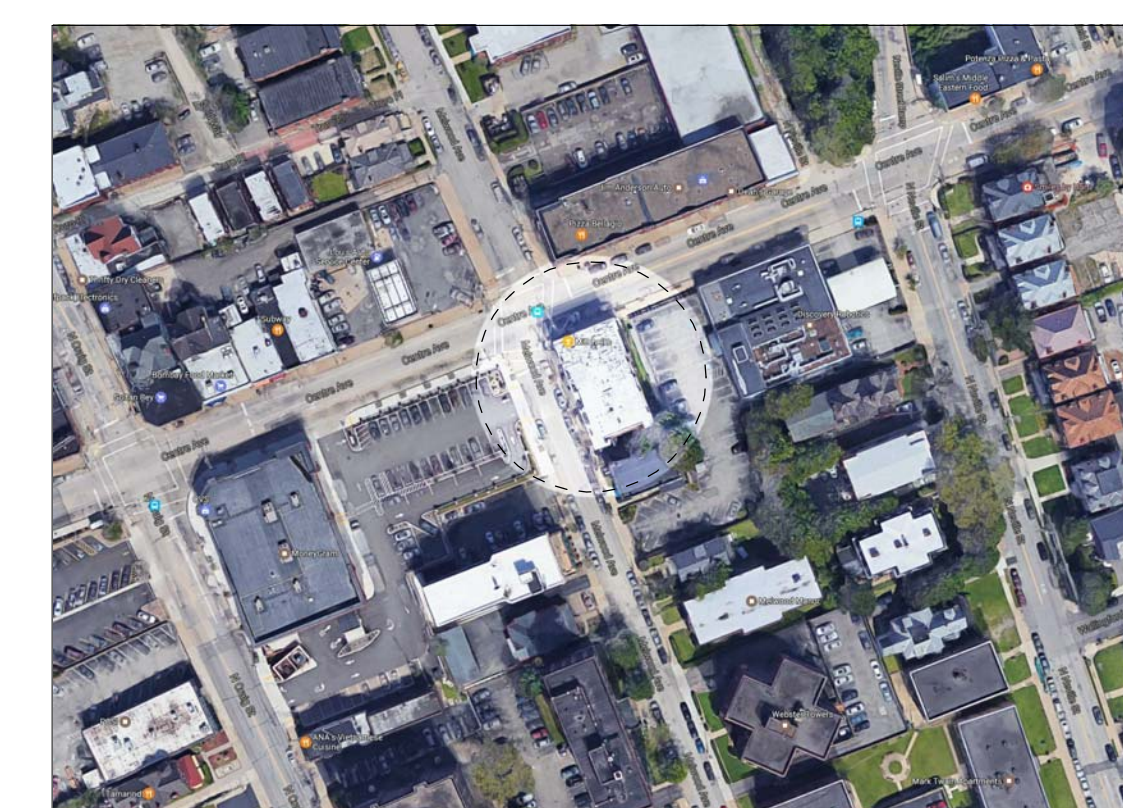

True North Project North

Aerial View of Site

12" = 1'-0"

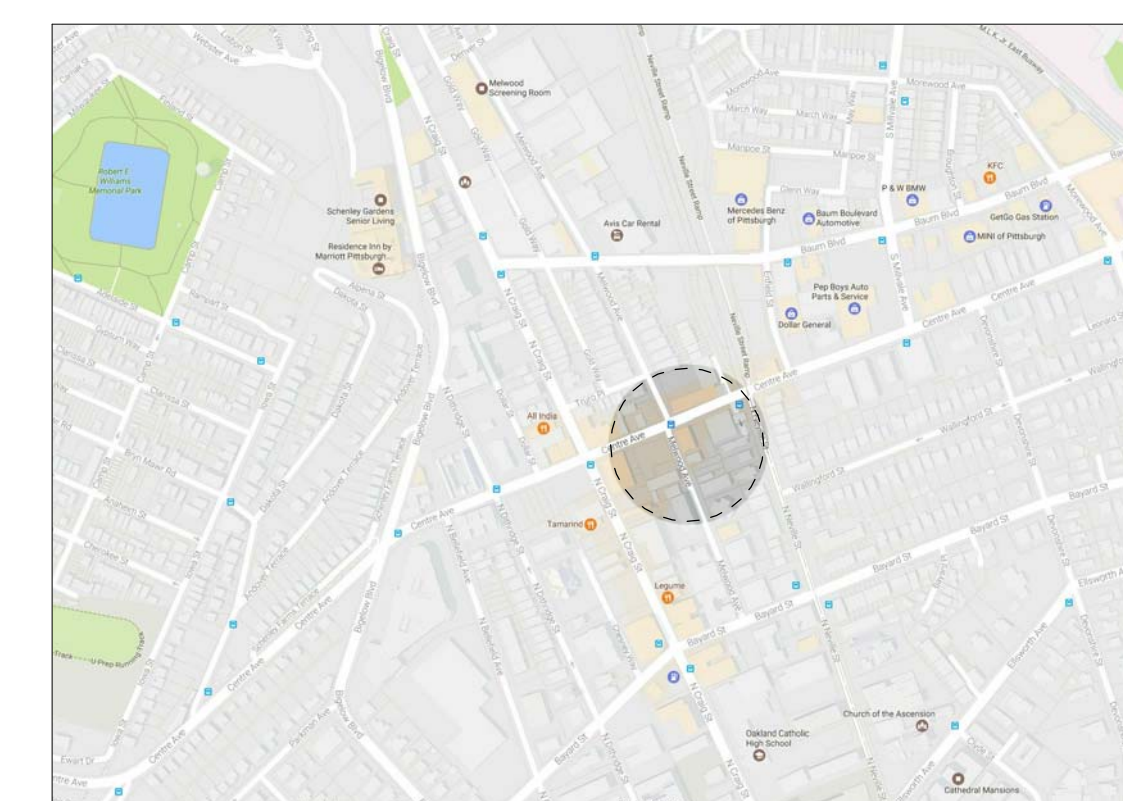

Area Map

12" = 1'-0"

Ertugrul Kilic 4632 Centre Avenue Renovation

4632 Centre Avenue
Pittsburgh, PA 15217

Construction Documents

Description	No.	Date

Date: 12.11.2017
Hart Arch Project No.: 1607.240

Site Improvements

S1.1

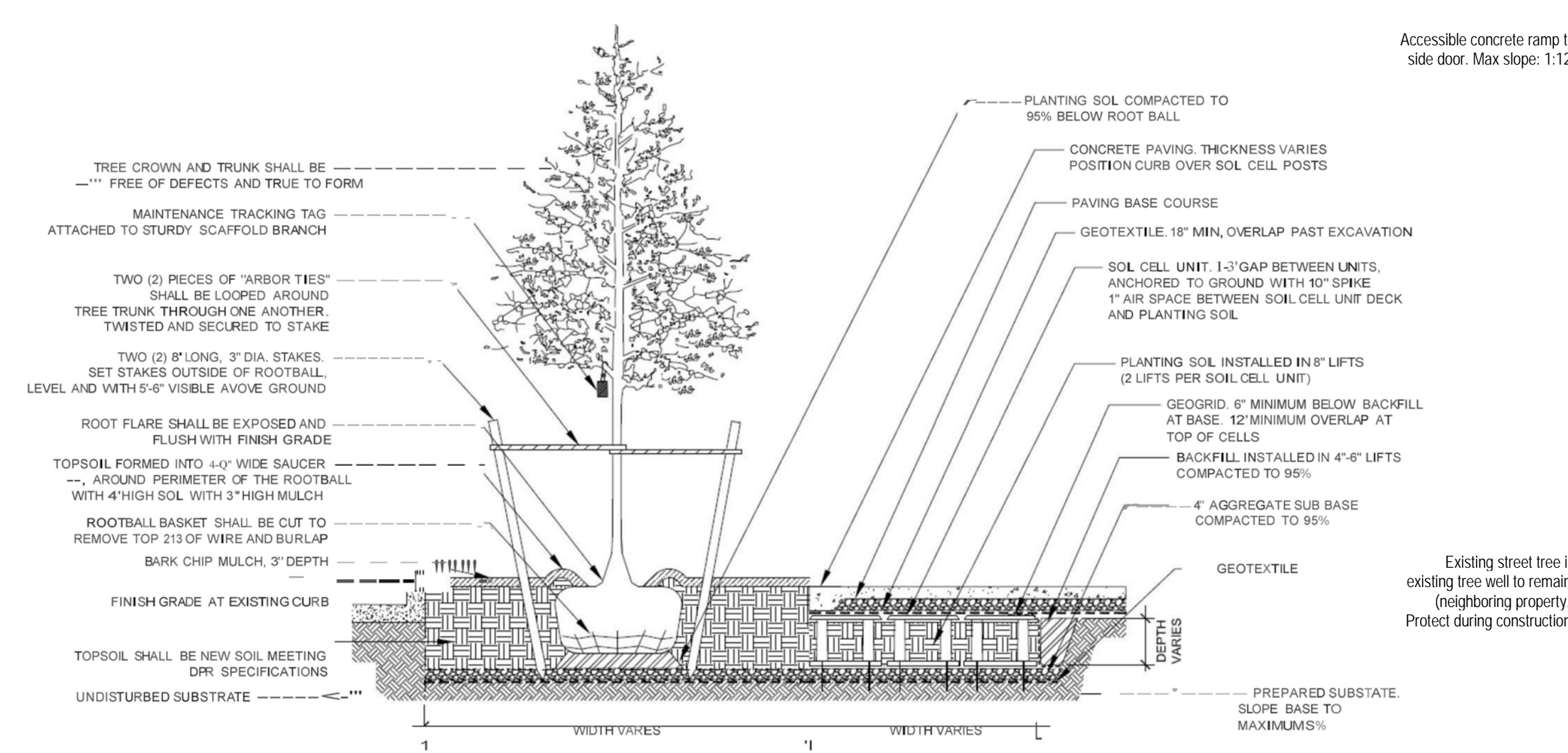

TREE PLANTING & SOIL CELL UNIT IN SINGLE LAYER DETAIL

NOT TO SCALE

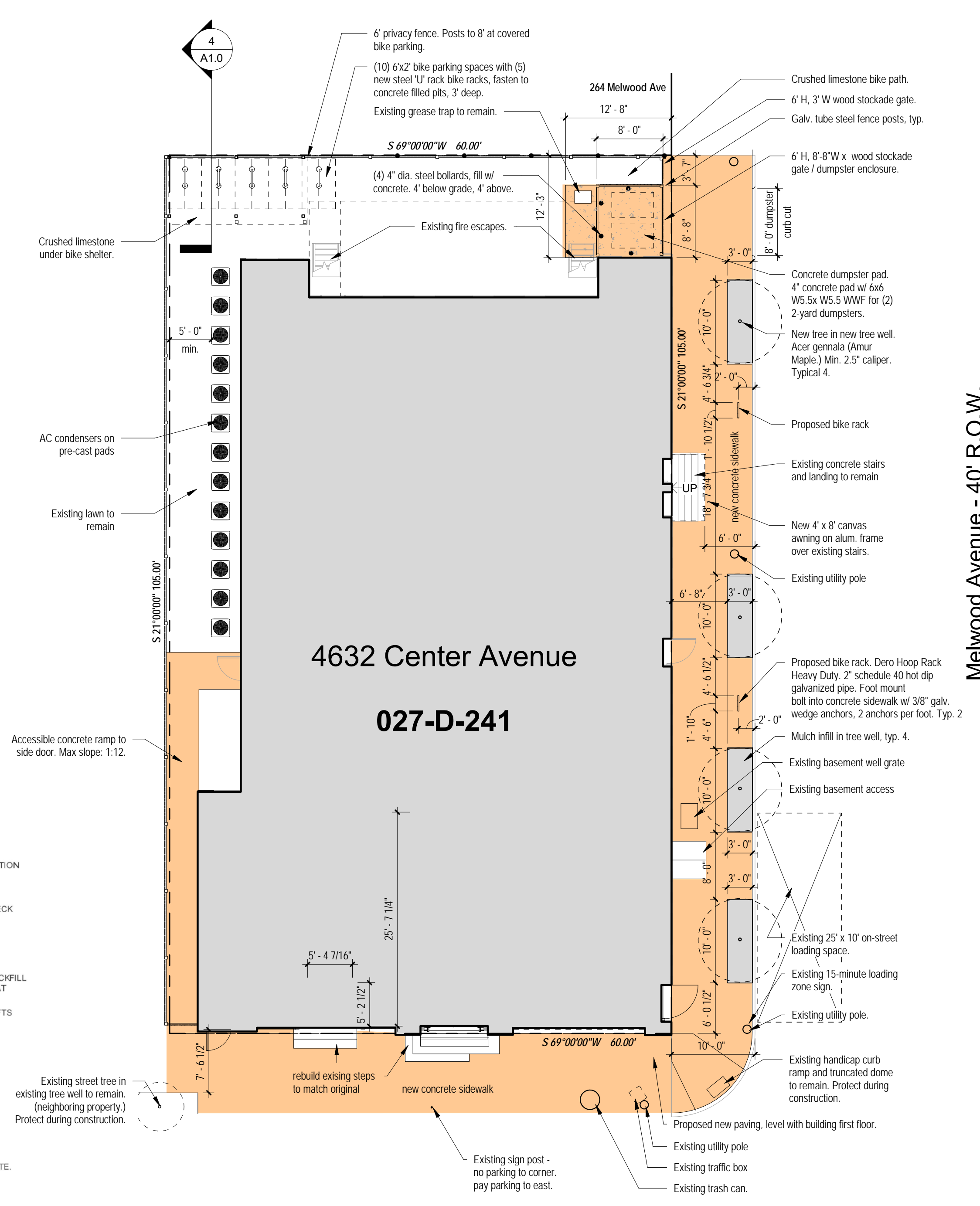

1 Site Improvements
1" = 10'-0"



11/16/2021 3:37:49 PM



Nathan Hart <nhart@hartarc.com>

17-B-01902 - 4632 Centre Ave - DOMI contact?

Nathan Hart <nhart@hartarc.com>

Thu, Nov 4, 2021 at 3:39 PM

To: "Ivoska, Amy" <amy.ivoska@pittsburghpa.gov>

Cc: "Potter, Kyle" <kyle.potter@pittsburghpa.gov>, "Salem, Mike" <mike.salem@pittsburghpa.gov>

Amy,

Thanks for the quick response. My apologies for not getting back to you sooner. We are absolutely swamped here and aren't taking on new projects until our current projects are further along. We're doing our best to work this re-application into our work load and between other deadlines and client permitting and construction emergencies. Any relief that DOMI can provide in that regard would be greatly appreciated. The owner has received a notice of violation for the work that was started and remains unfinished.

My responses to your comments are as follows:

- 1) The proposed curb cut for the dumpster is to Melwood, not to the adjacent property. For clarity, we have labelled the adjacent property (264 Melwood Ave)
- 2) We will file for an encroachment permit for these existing steps. As the contractor removed them during the course of the sidewalk work, we have noted that they will be rebuilt to match their previous footprint.
- 3) We will file for an encroachment permit for these existing steps and awning.
- 4) These 'U' bike racks were previously reviewed and approved by City Planning.
- 5) We will file for a sidewalk repair permit
- 6) We will file for a curb cut permit to Melwood. There are two types of curb cuts DOMI lists - Garage and Parking Pad. This is a dumpster pad. Please advise if we should file for a parking pad curb cut or something else.
- 7) This mechanical equipment will be removed if it hasn't been already.
- 8) These are ground mounted AC units. I have labelled them on the site plan.

I also recovered the site plan we had previously had permitted through Public Works, so I have attached it instead of the site plan we provided previously. I'll also upload it to the Onestop file. If you need any additional information, please let me know.

Thanks,

Nathan Hart, R.A.



603 Greenfield Avenue
Pittsburgh, PA 15207
office: 412 214 7550
cell: 412 726 1941
www.hartarc.com

On Fri, Oct 29, 2021 at 2:56 PM Ivoska, Amy <amy.ivoska@pittsburghpa.gov> wrote:

Hi Nathan,