

PROVIDING for the sale of certain property, acquired by the City of Pittsburgh at tax sales. ITEMS A through E: A: 136 Bodkin Street, B: 1232 Butterfield Way, C: 236 E Jefferson St, D: 3820 Perrysville Ave, E: 3516 Brighton Rd

The City Solicitor is hereby authorized to petition the Court of Common Pleas of Allegheny County for the sale of the following properties, acquired at tax sales in accordance with Act No. 171 of 1984. The advertisement of sale and deed to contain a stipulation that the property is being sold subject to all zoning, building and subdivision laws and ordinances, and the cost of the Court proceedings to be paid from Special Trust Fund, Three Taxing Bodies. Any and All properties contained in this Resolution may be the subject of advertising for sale by the Finance Department. ITEMS A through E: A: 136 Bodkin Street, B: 1232 Butterfield Way, C: 236 E Jefferson St, D: 3820 Perrysville Ave, E: 3516 Brighton Rd

**(A)**

Parys Durham  
2 STY STN-ALUM SDG HSE  
PURCHASE PRICE: \$40,000.00  
Residential Rehab - Rental  
LOT: LOT 50 X AVG 101 X 55  
LOCATION: 136 Bodkin Street  
ACQUIRED: April 29, 2016 T/S# 349  
WARD: 19 BLOCK & LOT: 62-K-200  
COUNCIL DISTRICT: 4

**(B)**

Matthew Williamson & Laura Pascal  
PURCHASE PRICE: \$21,000.00  
New Construction- Residential  
LOT: LOT 15 X 110  
LOCATION: 1232 Butterfield Way  
ACQUIRED: October 28, 2016 T/S# 203  
WARD: 22 BLOCK & LOT: 23-K-388  
COUNCIL DISTRICT: 1

**(C)**

Jeffrey Dewey  
PURCHASE PRICE: \$15,600.00  
New Construction- Residential  
LOT: LOT PTS 60-61 LOT 15 X 42 PT 60 LOT 15 X 40  
LOCATION: 236 E Jefferson St  
ACQUIRED: August 14, 2015 T/S# 149  
WARD: 25 BLOCK & LOT: 23-F-131  
COUNCIL DISTRICT: 6

**(D)**

Melvin McCormick  
2 STY BRK V HSE C B GAR  
PURCHASE PRICE: \$35,000.00  
Rehab to Occupy  
LOT: LOT 50.11 X AVG 80.33 X 50  
LOCATION: 3820 Perrysville Ave  
ACQUIRED: April 20, 2018 T/S# 215  
WARD: 26 BLOCK & LOT: 115-H-51  
COUNCIL DISTRICT: 1

**(E)**

Julie Barry  
2 STY BRK & ALUM SDG HSE 1 STY BRK GAR  
PURCHASE PRICE: \$50,000.00  
Rehab to Occupy  
LOT: LOT 39.36 X 70  
LOCATION: 3516 Brighton Rd  
ACQUIRED: August 14, 2015 T/S# 194  
WARD: 27 BLOCK & LOT: 76-A-232  
COUNCIL DISTRICT: 1

City of Pittsburgh  
Department of Finance  
Property Fact Sheet

---

**Property Information**

**Property Address:** 136 BODKIN ST  
Pittsburgh, PA 15226

**Block & Lot:** 62-K-200

**Zoned As:** R1D-M

**Neighborhood:** Brookline

**Council District:** 04

**Ward:** 19

**Census Tract:** 1919

**Description:** LOT 50XAVG101X55 RR BROOKLINE BLVD | 2 STY STN-ALUM SDG HSE 136 |

---

**Adjoining Properties:** In a residential neighborhood on Bodkin Street and the adjoining properties are a 2 STY SHG HSE \$73,500.00, a 2 STY BRK DWLG assessed at \$86,500.00, a 2 STY BRK V DWLG & GAR assessed at \$88,100.00 and a 2 STY BRK V DUPLEX-GAR assessed at \$86,200.00

---

**Purchase Price:** \$40000.00

**Intended Use:** Residential Rehab - Rental

**Permitted Under Zoning:** Yes

**Purchaser Information**

**Purchaser:** Parys Durham  
**Address:** 833 Farragut St  
Pittsburgh, PA

**Delinquent Taxes / Payment Plans:** No

**Building Violations:** No

**Delinquent Water/Sewage Charges:** No

**Approved:** Yes

\*City Employee

---



City of Pittsburgh  
Department of Finance  
Property Fact Sheet

---

**Property Information**

**Property Address:** 1232 Butterfield Way  
Pittsburgh, PA 15212.0

**Block & Lot:** 23-K-388

**Zoned As:** R1A-VH

**Neighborhood:** Central Northside

**Council District:** 01

**Ward:** 22

**Census Tract:** 2206

**Description:** LOT 15X110 REDDOUR ST BET ELOISE & SAMPSON ST | |

---

**Adjoining Properties:** In a residential neighborhood on Butterfield Way and the adjoining properties are a LOT 15X63 assessed at \$500, a LOT 15X47 assessed at \$400 and a LOT 16.67X110 assessed at \$900

---

**Purchase Price:** \$21000.00

---

**Intended Use:** New Construction - Residential

**Permitted Under Zoning:**

**Purchaser Information**

**Purchaser:** Laura Pascal  
**Address:** 1301 Reddour St  
Pittsburgh, PA

**Approved:** Yes

**Delinquent Taxes / Payment Plans:** No  
**Building Violations:** No  
**Delinquent Water/Sewage Charges:** No

**Purchaser:** Matthew Williamson  
**Address:** 1301 Reddour St  
Pittsburgh, PA

**Approved:** Yes

**Delinquent Taxes / Payment Plans:** No  
**Building Violations:** No  
**Delinquent Water/Sewage Charges:** No



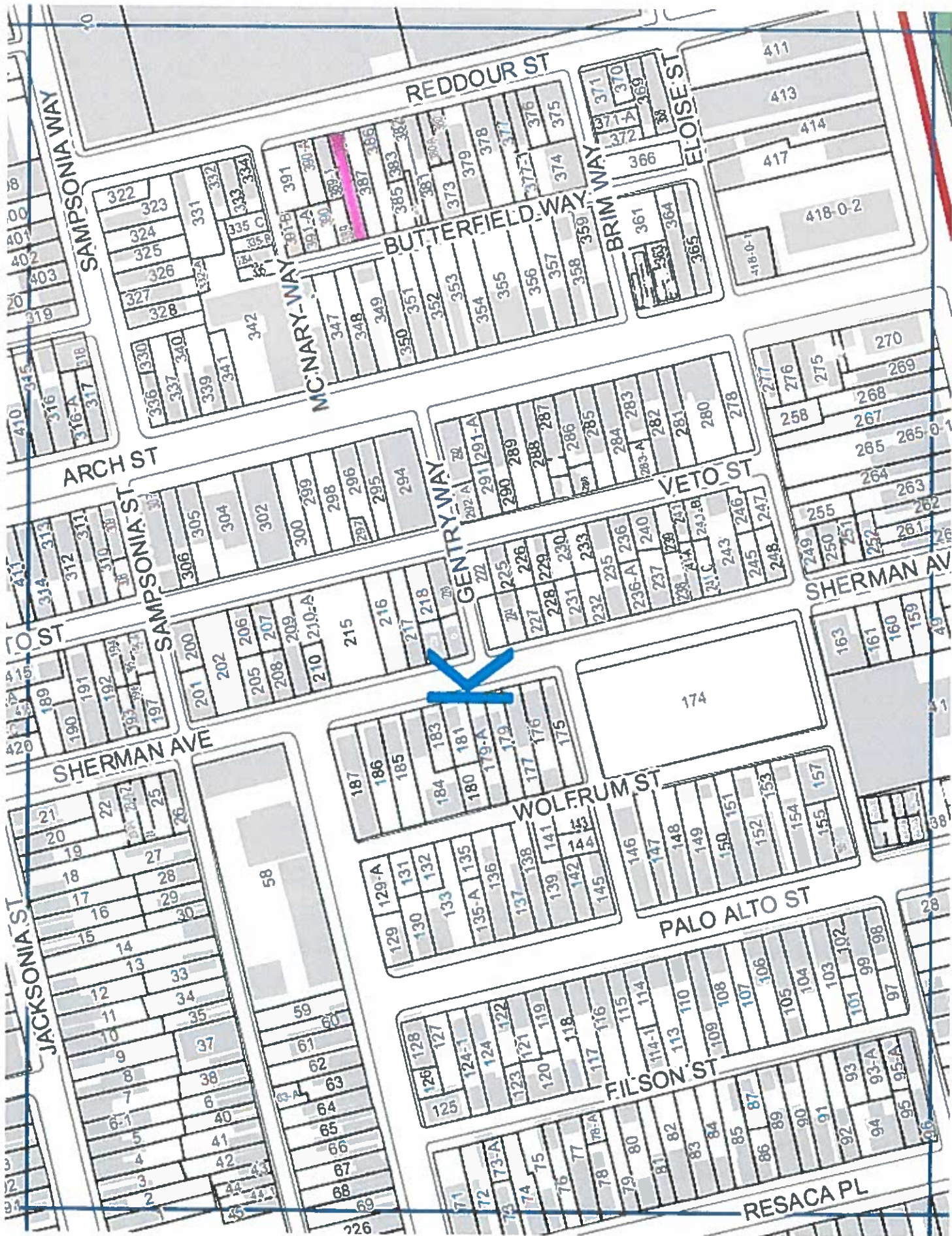

City of Pittsburgh  
Department of Finance  
Property Fact Sheet

---

**Property Information**

**Property Address:** 236 E JEFFERSON ST  
Pittsburgh, PA 15212.0

**Block & Lot:** 23-F-131

**Zoned As:** R1A-VH

**Neighborhood:** Central Northside

**Council District:** 06

**Ward:** 25

**Census Tract:** 2503

**Description:** GEO LEDIES SUB DIV PLAN PTS 60-61 LOT 15X42IN A | LL JEFFERSON ST | GEO LEDIES SUB DIV PLAN PT 60 LOT 15X40 JEFFERS

---

**Adjoining Properties:** In a residential neighborhood on E Jefferson Street and the adjoining properties are a LOT 15X100 assessed at \$4,500.00 and a 2 STY FRA TOWNHOUSE assessed at \$336,500.00

---

**Purchase Price:** \$15600.00

**Intended Use:** New Construction - Residential

**Permitted Under Zoning:** Review

**Purchaser Information**

**Purchaser:** Jeffrey Dewey

**Delinquent Taxes / Payment Plans:** No

**Address:** 3708 Mintwood St  
Pittsburgh, PA

**Building Violations:** No

**Approved:** Yes

**Delinquent Water/Sewage Charges:** No



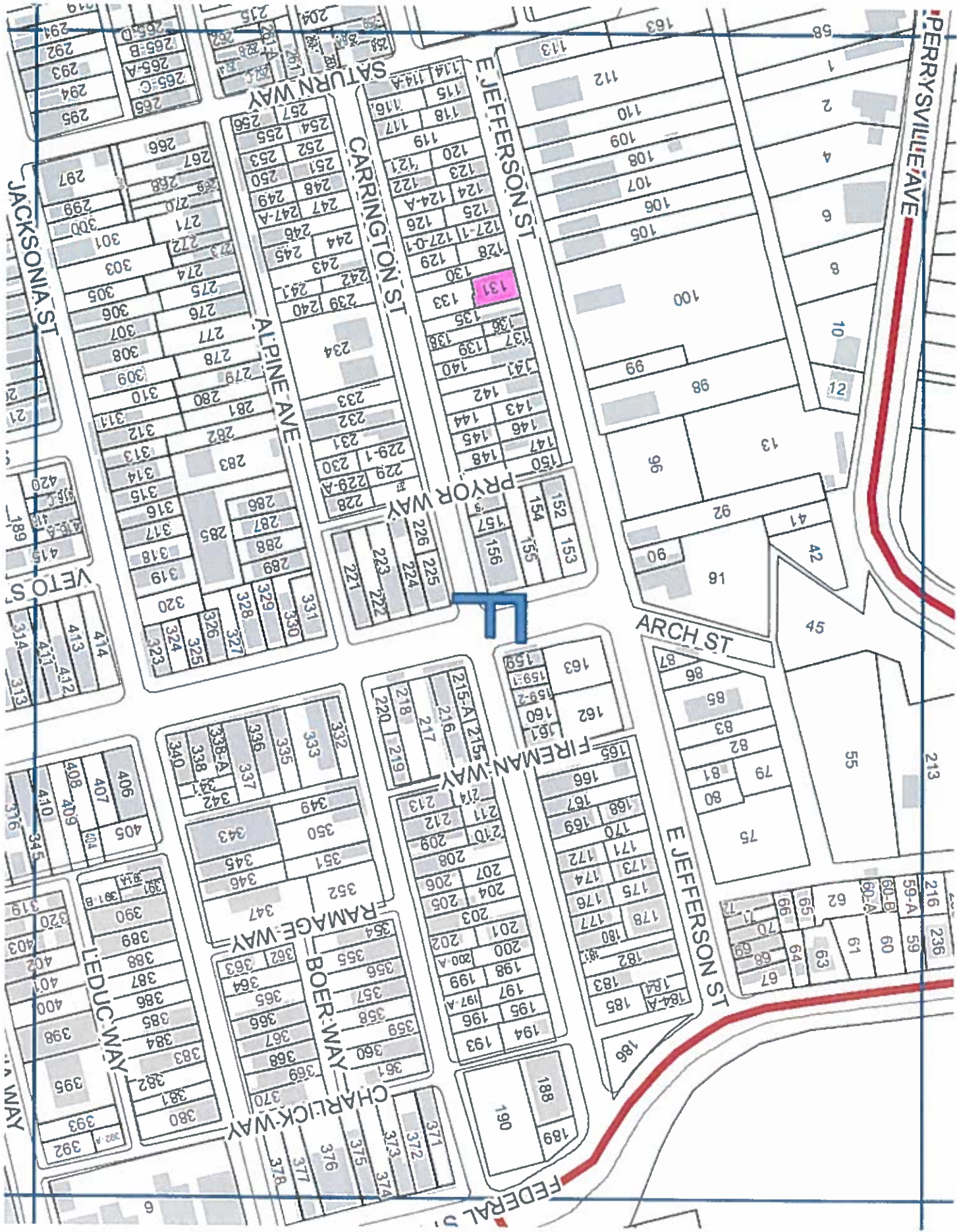

23



City of Pittsburgh  
Department of Finance  
Property Fact Sheet

---

**Property Information**

**Property Address:** 3820 Perrysville Ave  
Pittsburgh, PA 15214

**Block & Lot:** 115-H-51

**Zoned As:** R1D-M

**Neighborhood:** Perry North

**Council District:** 01

**Ward:** 26

**Census Tract:** 2607

**Description:** LOT 50.11XAVG80.33X50 RR PERRYSVILLE AVE

---

**Adjoining Properties:**

In a residential neighborhood on Perrysville Avenue and the adjoining properties are a 2 STY BRK V HSE C B GAR assessed at \$72,500.00, a 1 1/2 STY FRA HSE assessed at \$59,000.00 and a 2 1/2 STY BRK DBLE HSE assessed at \$84,900.00

---

**Purchase Price:** \$35000.00

**Intended Use:** Residential Rehab - Occupy

**Permitted Under Zoning:** Yes

**Purchaser Information**

**Purchaser:** Melvin McCormick

**Address:** 1235 Coronado Ln  
Duncanville, TX

**Approved:** Yes

**Delinquent Taxes / Payment Plans:** No

**Building Violations:** No

**Delinquent Water/Sewage Charges:** No



115

115-G-225

115-G-225

SEMICIR ST

DE FOEST ST

WALES WAY

HEMPHILL ST

PERRYVILLE AVE

EAST ST



51

City of Pittsburgh  
Department of Finance  
Property Fact Sheet

---

**Property Information**

**Property Address:** 3516 BRIGHTON RD  
Pittsburgh, PA 15212.0

**Block & Lot:** 76-A-232

**Zoned As:** H

**Neighborhood:** Brighton Heights

**Council District:** 01

**Ward:** 27

**Census Tract:** 2708

**Description:** HARBISON ADDN TO BRIGHTON HTS PT 5 LOT 39.36X70 | BRIGHTON RD | 2 STY BRK & ALUM SDG HSE 3516

---

**Adjoining Properties:** In a residential neighborhood on Brighton Road and the adjoining properties are a 2 STY BRK & ALUM SDG HSE 1 STY GAR assessed at \$55,400.00, a 2 STY BRK & FRA HSE assessed at \$59,800.00 and a LOT 30.22XAVG89.90X30 RR assessed at \$1,000.00

---

**Purchase Price:** \$50000.00

**Intended Use:** Rehab to Occupy

**Permitted Under Zoning:** Yes

**Purchaser Information**

**Purchaser:** Julie Barry

**Address:** 16 Villa Ct  
Pittsburgh, PA

**Approved:** Yes

**Delinquent Taxes / Payment Plans:** No

**Building Violations:** No

**Delinquent Water/Sewage Charges:** No





A

232