

GENERAL NOTES

1. THE LOCATIONS OF EXISTING UNDERGROUND UTILITIES ARE SHOWN IN AN APPROXIMATE WAY ONLY AND HAVE NOT BEEN INDEPENDENTLY VERIFIED BY THE OWNER OR ITS REPRESENTATIVE. THE CONTRACTOR SHALL DETERMINE THE EXACT LOCATION OF ALL EXISTING UTILITIES BEFORE COMMENCING WORK, AND SHALL BE FULLY RESPONSIBLE FOR ANY AND ALL DAMAGES WHICH MIGHT BE OCCASIONED BY THE CONTRACTOR'S FAILURE TO EXACTLY LOCATE AND PRESERVE ANY AND ALL UNDERGROUND UTILITIES.
2. WHERE AN EXISTING UTILITY IS FOUND TO CONFLICT WITH THE PROPOSED WORK, THE LOCATION, ELEVATION AND SIZE OF THE UTILITY SHALL BE ACCURATELY DETERMINED WITHOUT DELAY BY THE CONTRACTOR, AND THE INFORMATION FURNISHED TO THE ENGINEER FOR RESOLUTION OF THE CONFLICT.
3. THE CONTRACTOR SHOULD MAINTAIN A SEPARATION OF 18 INCHES MIN. WHEN CROSSING EXISTING WATER FACILITIES.
4. THE CONTRACTOR SHALL MAKE ALL ARRANGEMENTS FOR THE ALTERATION AND ADJUSTMENT OF GAS, ELECTRIC, TELEPHONE AND ANY OTHER PRIVATE UTILITIES BY THE UTILITY COMPANY.
5. THE CONTRACTOR SHALL NOT DISTURB PUBLIC TREES AND SHRUBS.
6. AREAS OUTSIDE THE LIMITS OF PROPOSED WORK DISTURBED BY THE CONTRACTOR'S OPERATIONS SHALL BE RESTORED BY THE CONTRACTOR TO THEIR ORIGINAL CONDITION AT NO EXPENSE TO THE OWNER.
7. THE CONTRACTOR SHALL BE RESPONSIBLE FOR PLACING AND MAINTAINING TEMPORARY RESURFACING AND/OR PLATING FOR ALL EXCAVATIONS IN PAVED STREETS AND SIDEWALKS UNTIL PERMANENT RESURFACING IS COMPLETE.
8. JOINTS BETWEEN NEW BITUMINOUS CONCRETE ROADWAY PAVEMENT AND SAW CUT EXISTING PAVEMENT SHALL BE SEALED WITH BITUMEN AND BACK SANDED.
9. THE CONTRACTOR SHALL PROTECT AND SUPPORT ALL EXISTING UTILITY LINES THAT BECOME EXPOSED DUE TO EXCAVATION REQUIRED TO INSTALL THE PROPOSED CONDUIT.
10. THE CONTRACTOR SHALL REPLACE ALL DISTURBED TRAFFIC SIGNAL LOOP DETECTORS TO GOOD WORKING CONDITION AS REQUIRED BY THE LATEST STANDARDS OF THE MUNICIPAL TRAFFIC DEPARTMENT.
11. ALL EXISTING STATE, COUNTY, CITY, AND TOWN LOCATION LINES AND PRIVATE PROPERTY LINES HAVE BEEN ESTABLISHED FROM AVAILABLE INFORMATION AND THEIR EXACT LOCATION ARE NOT GUARANTEED.
12. THE CONTRACTOR SHALL REPLACE ALL PAVEMENT MARKINGS IN THEIR ENTIRETY THAT HAVE BEEN DAMAGED BY TRENCH EXCAVATION OR OPERATIONS OF THE CONTRACTOR WITH SIMILAR COLOR AND SIZE THERMOPLASTIC MARKINGS.

*** - ITEM SHOWN ON UTILITY RECORDS, BUT NOT FOUND IN FIELD.**

~ - ITEM FOUND IN FIELD, BUT NOT SHOWN ON UTILITY RECORDS

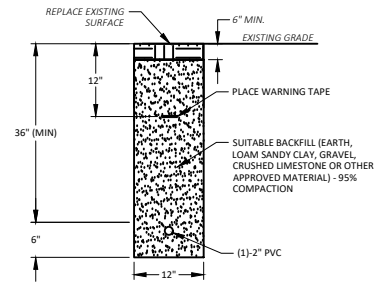

PROPOSED DUCT CONFIGURATION
SOFT SHOULDER PATCH AND DUCT BANK INSTALLATION DETAIL
N.T.S.

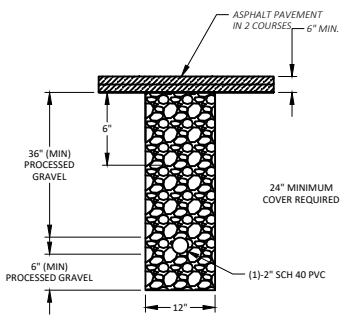

PROPOSED DUCT CONFIGURATION
ROADWAY PATCH AND DUCT BANK INSTALLATION DETAIL
N.T.S.

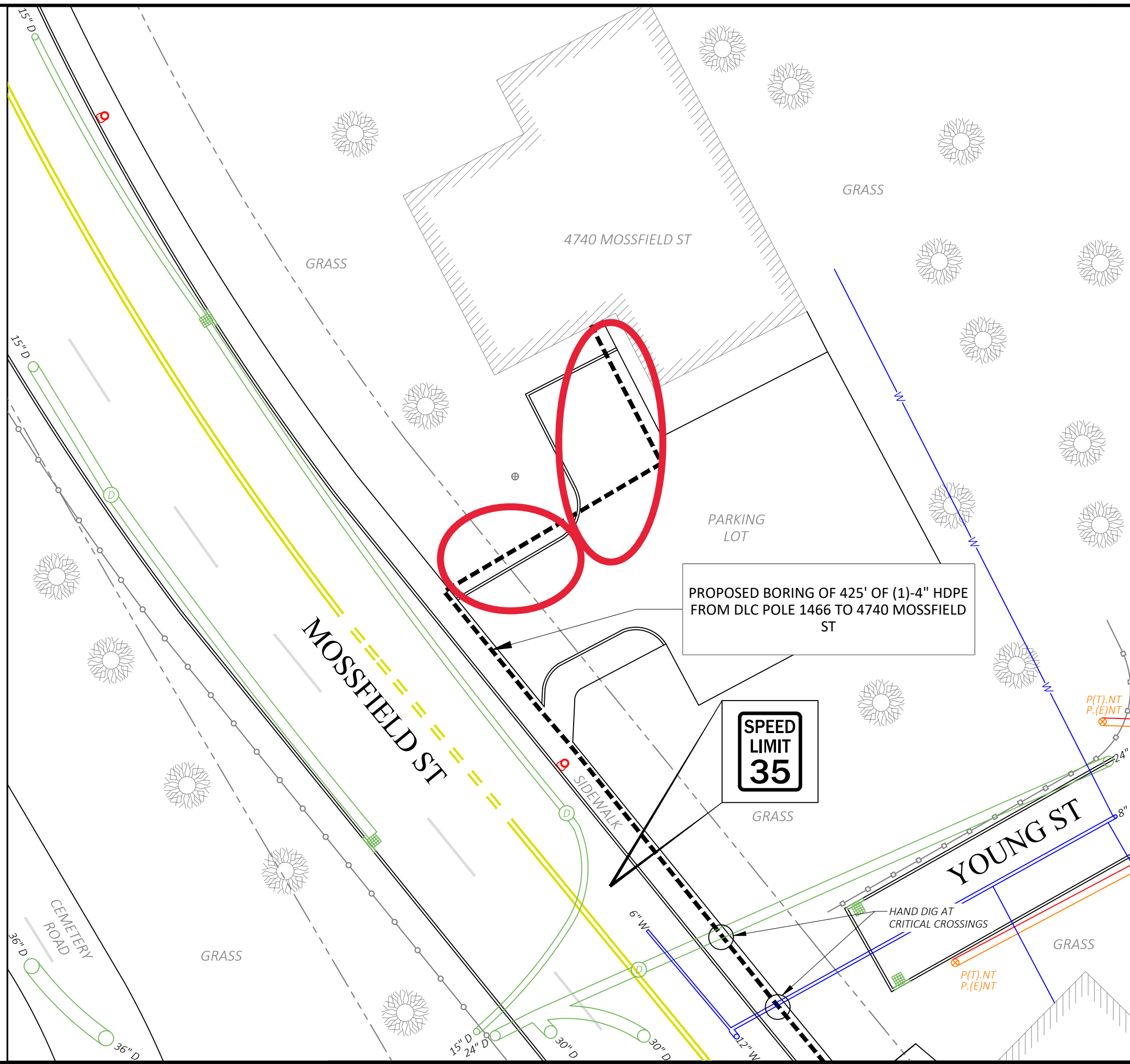

PROPOSED BORING OF 425' OF (1)-4" HDPE FROM DLC POLE 1466 TO 4740 MOSSFIELD ST

SPEED LIMIT 35

SUE SCORE - 2.2

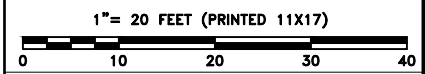

LEGEND			
⊗	ELECTRIC POLE	⊠	CATCH BASIN
⊕	JOINT UTILITY POLE	⊞	CATV HANDHOLE
⊙	LAMP POST	⊞	COMM PEDESTAL
⊙	TRAFFIC LIGHT	⊞	ELECTRIC HANDHOLE
⊙	CATV MANHOLE	⊞	FIRE HYDRANT
⊙	DRAIN MANHOLE	⊞	GAS GATE
⊙	ELECTRIC MANHOLE	⊞	GAS METER
⊙	SEWER MANHOLE	⊞	IRRIGATION VALVE
⊙	TELEPHONE MANHOLE	⊞	MAIL BOX
⊙	WATER MANHOLE	⊞	PARKING METER(S)
⊙	POLE ANCHOR GUY	⊞	SEWER GATE
⊙	BUSH/SHRUB	⊞	SIGN POLE
⊙	RIGHT OF WAY	⊞	STEEL POST
⊙	CULVERT	⊞	STREET LIGHT
⊙	FENCE	⊞	TEL HANDHOLE
⊙	GUARD RAIL	⊞	TRANSFORMER
⊙	ELECTRIC VAULT	⊞	UG CABLE MARKER
⊙	TRAFFIC HANDHOLE	⊞	WATER GATE
⊙	PROPOSED HANDHOLE	⊞	WATER METER
⊙	PROPOSED CONDUIT	⊞	EX. UG GAS
⊙	EX. UG WATER	⊞	EX. UG DRAIN
⊙	EX. UG TRAFFIC	⊞	EX. UG SEWER
⊙	EX. UG ELCO	⊞	EX. UG TELCO
⊙	EX. OH ELCO	⊞	EX. OH TELCO

NOTE:
EXISTING UTILITIES SHOWN ARE APPROXIMATE AND NOT WARRANTED TO BE CORRECT. THE CONTRACTOR SHALL VERIFY THE LOCATION OF ALL PUBLIC AND PRIVATE UTILITIES PRIOR TO BEGINNING ANY EXCAVATION.

CALL BEFORE YOU DIG
UNDERGROUND SERVICE ALERT
72 HOURS NOTICE REQUIRED.
ENTER 1-888-DIG-SAFE

PREPARED BY:
PIKE TELECOM
501 Holiday Drive
Pittsburgh, PA 15220
www.piketecom.com
412-688-3555

PREPARED FOR:
CROWN CASTLE

REV #	DESCRIPTION	DATE

TITLE:
4740 MOSSFIELD ST
PITTSBURGH, PA 15224
CROWN CASTLE - PETITION PLAN

SURVEYED BY: PIKE	PRINT NO: 4 OF 7
DRAWN BY: IJD	SCALE: AS NOTED
DATE: 9/7/23	AS-BUILT: