



Public Art & Civic Design Commission

Hearing & Action Application

Woods Run Carnegie Library Street Mural	
Applicant Name	Eric Boerer
Applicant Organization	Bike Pittsburgh
What is your relationship to the project?	Project Manager
Co-applicant	n/a
Who will be representing this project at a hearing?	Eric Boerer, BikePGH; Ashley Kyber, artist
Prior Commission Review	Preliminary Reviews 11-23, 1-24
Project Address	1201 Woods Run Ave, Pittsburgh, PA 15212
Cross Streets and/or other relevant location information	This is in front of the Carnegie Library of Pittsburgh, Woods Run Branch.
Neighborhood	Woods Run (Border of Brighton Heights and Marshall-Shadeland)
Development Activities Meeting	Held March 2024
Project Duration	We intend to install the mural in early summer 2024. Per our Maintenance agreement with DOMI, we will need to either remove the mural or ask for an extension after 3 years. <i>Staff note: Similar to other limited-term public art projects, staff recommends initial approval for a set period of time (~3-5 years), with extensions being given if artwork is adequately maintained during this term.</i>
Please give a summary description of the project.	<p>The City's Department of Mobility and Infrastructure has completed the "Trail to Mairdale" Neighborway and traffic calming project on Woods Run Ave connecting the Chateau Trail and Riverview Park. DOMI's project added many pedestrian and bike friendly features along this segment of road to calm traffic and promote safety. We intend to supplement the DOMI project with a street mural in a section of their design that created a large, triangle-shaped area of blank asphalt directly in front of the Carnegie Library, Woods Run Branch. This curved section of road is notorious for enabling drivers to speed around the bend, but is now narrowed with a car free section of blank asphalt. The area is a perfect canvas to add public art to create a sense of place, showcase the neighborhood, further calm traffic and to reduce the heat effect of a large section of black asphalt.</p> <p>From BikePGH's bike rack initiative in 2004, to the more recent MoveForwardPGH program (2020-2022), we have partnered with the Department of City Planning, the Department of Public Works, and now the Department of Mobility and Infrastructure on a number of projects in the</p>

public realm that achieve both of our goals. Two decades of working closely with the City has allowed BikePGH to be seen as trusted partners in helping make Pittsburgh's streets friendlier for walking and biking.

Asphalt mural art has emerged as an effective way to help calm traffic and to create vibrant places on top of large areas of street surface. The benefits of such projects extend beyond aesthetics. A March 2022 Asphalt Art Safety Study, conducted by Sam Schwartz Consulting in partnership with Bloomberg Philanthropies, found that city streets with asphalt art became considerably safer for pedestrians after incorporating art into roadway redesign, and can contribute to increased pedestrian traffic, improved road safety, reduced urban heat island effect, and a greater sense of civic pride.

Comparing the average of crash rates for before-after the analysis periods, results from the crash analysis of the study include:

- » 50% decrease in the rate of crashes involving pedestrians or other vulnerable road users
- » 37% decrease in the rate of crashes leading to injuries
- » 17% decrease in the total crash rate

Similarly, the Observational Behavior Assessment of the study indicates:

- » 25% decrease in pedestrian crossings involving a conflict with drivers
- » 27% increase in frequency of drivers immediately yielding to pedestrians with the right of way
- » 38% decrease in pedestrians crossing against the walk signal

Link to study: <https://assets.bbhub.io/dotorg/sites/43/2022/04/Asphalt-Art-Safety-Study.pdf>

By reclaiming public spaces for artistic expression, we can create safer, more welcoming environments for all members of our community to enjoy. Due to the success of previous asphalt art projects and their demonstrated safety benefits, DOMI agrees, and is looking to increase the use of asphalt art to help achieve their safety goals and enhance the positive traffic calming effects of their projects.

Through a grant from AARP (Up to \$12K of which is earmarked for this project), we are collaborating with the Northside's CLP Woods Run Library (Ian Eberhardt, Branch Manager), DOMI, landscape architect and public artist Ashley Kyber (listed in the Office of Public Art Directory), and Tom Higgs, a Pittsburgh CAPA digital media and sculpture teacher. There are few artists with experience in asphalt art, so Ashley was selected based on her experience, previous work and credentials creating four community-driven asphalt art projects in Pennsylvania and West Virginia. Tom Higgs worked with Kyber on a recent asphalt mural for Rivers of Steel in Monongahela, PA and was initially brought in as a painting contractor. However, once Higgs was invited to participate in the design engagements held at CLP Woods Run, he became further involved as it was discovered that Woods Run is Higgs' childhood home and his family still lives here. Higgs was jubilant to

find an opportunity to engage and offered further support by bringing the project into his classroom and recruiting students to vision the project and participate in the painting. There are four CAPA Art students participating that are also from the Woods Run neighborhood.

The site itself was originally chosen based off of DOMI's recommendation as an ideal location for asphalt art, since the traffic engineering has already been completed. Further, the CLP Woods Run Library has been an enthusiastic partner, and are considering the mural a "welcome mat" to the building. We are hoping that the mural can be part of their 60th anniversary celebration of their current location later this summer.

A three staged hands-on process was developed to allow residents a means for public engagement. This robust process allowed for neighborhood citizen engagement involving residents, library patrons, students and community groups via three design workshop sessions held on-site at the library with lead designer Ashley Kyber and two teaching artists. The goal of these sessions was to flesh-out the visual elements that citizens would like to see represented in the final design and to guide the second stage of the design process. Once the citizens developed the design ideas and content, the project was passed to students at Pittsburgh Public School's CAPA visual arts department under the leadership of Tom Higgs for the second stage of the process. Three neighborhood students are in the group working on the project. Ideations from the initial design engagements held at the library were polished into final design layouts on the site plan, and generated three options that were passed back to the community for input via the third and final engagement component hosted on the City's Engage Page and inside the library itself. Residents were able to rank their favorite designs and provide feedback. The outcome of this online voting process revealed that one concept garnered about half of the votes, while the other two evenly split the other half, giving the team an assurance that we should move forward with the winning concept.

The mural theme "bikes and books" incorporates both sponsors of the project and allows place-based design elements, chosen by citizen residents via the three-stage engagement process to be incorporated into the design. Some of these elements include historical buildings in the skyline in proximity of the library, a park-like tree lined setting, a book opening at the foot of the library entrance that allows the passerby to perceive the imagery of the mural arising from the open pages. During one of the sessions, a resident and self-described neighborhood historian, walked us through the historic and significant architecture of the area, including the now demolished St Leo's church, formerly an important community gathering location (much like the Library is today), as well as the original Woods Run Library building located a few blocks away and now a daycare. As the Library is currently celebrating its 60th anniversary of their current location, we thought incorporating the original location into the design was an important homage to the history of the institution's place in Woods Run. Design elements also highlight the Library's central

	<p>location between Riverview Park and the Ohio River and Chateau River Trail, with the large wooded areas in between. DOMI already completed the engineering and installation of the area to be painted in 2023, and we are tasked with filling the now empty space. The project manager/engineer at DOMI who we've been working with on the space is Paige Anderson.</p> <p>Citizen Selected Mural Elements: Historical Buildings including St. Leo’s Church, original Carnegie Library and the Observatory A “grandmother” tree to denote large old growth trees in park and an overall wooded/park setting showing bike access Book opening into story of place - Book located at library entrance Bike parts, a gaggle of bikers Day to night theme with sun, clouds and stars The mural also has a bit of a mapping and wayfinding element to it. If you emerge from the library, to the right would be Riverview Park, and to the left would be the river (shown at the far left of the design)</p> <p>Once these elements were established two layouts were created in Adobe Illustrator with each design element created as an original and compiled into two layouts by Kyber. A third option for citizen voting was generated by Heather Macayko, a CAPA student. Tom Higgs and CAPA students had in-put and layout design input throughout the process. Tom Higgs and Students will create the stencils needed from the original art generated in Adobe Illustrator to be used for the pavement epoxy squeegee installation process. Paint-out will be a two day process with Pittsburgh CAPA students and faculty joined by BikePGH and Library volunteers, ideally in May 2024.</p>
<p>Who is this project intending to be used or experienced by?</p>	<p>We foresee two audiences: 1) Library patrons and local residents, and 2) drivers in the corridor. As this is directly in front of the library, it will not only act as a welcome mat to this important community resource, but also be seen as patrons enter and exit the building. This will create a welcoming sense of place for those in the neighborhood. Additionally, Woods Run Ave is used as a cut-through for many drivers, so the intention is to also enhance DOMI's traffic calming project to help discourage drivers from speeding, especially in front of the Library, where there is not only a history of crashes, but there are many children coming and going on foot and on bikes. Asphalt Mural Art can change the environment for drivers, reducing the overall kinetic energy of an urban space.</p>
<p>What users/stakeholders/community members have been involved so far?</p>	<p>First and foremost, we have been collaborating closely with the CLP Woods Run branch manager, Ian Eberhardt. With him, and landscape architect and public artist Ashley Kyber, we have hosted three community brainstorming sessions over three months on Saturday Oct 2, Thursday Nov 9 and Saturday Dec 2 2023.</p> <p>Woods Run Ave is the border between two neighborhoods (although the project is technically in Marshall Shadeland), and we've met and discussed the project with the Brighton Heights Citizens Federation as well as the Marshall Shadeland Civic Group, both of whom gave initial support to the</p>

project, and in general support initiatives that enhance the Library, as demonstrated during our Development Activities Meeting. We've discussed the project with Joe Glassbrenner from the Brighton Heights CF. I've attended a monthly meeting with the Marshall Shadeland Civic Group on the invitation of Jaime Younger (Group President), who is supportive of the project and was pleased to hear that we were working with local youth to generate ideas. Finally, we attended a joint Development Activities Meeting with these two Registered Community Organizations, hosted by the Department of City Planning.

Additionally, we have reached out to Councilmen Wilson and Lavelle's offices. So far, Wilson is very supportive. Councilman Lavelle's office is aware of the project, but we have yet to hear any feedback. As far as community groups, we have talked to the Northside Leadership Conference who have shared the various stages of the project on their platforms.

The three community brainstorming sessions over three months included many library patrons (between 10-15 per session), including children, neighbors and community members who were given sheets of paper and prompts to help brainstorm ideas. Others from the neighborhood attended to give their ideas for the mural, which mainly revolved around history and some notable buildings that are no longer standing (eg. St Leo's Church). We also worked with Tom Higgs, a CAPA teacher who grew up in the area, and his class, some of whom attended the sessions to help facilitate the community brainstorm and ultimately refine the design.

There was an online outreach component, both in BikePGH's vast network, the City's Engage platform and the CLP Woods Run Branch's direct email list. BikePGH has a large online reach with the following media counts: 20K email list, 20.8K Twitter/X, 21K Facebook, 16.6K Instagram. In addition, we have a significant membership base in the Northside, who we reached out to directly about the project. The aforementioned community groups and the Northside Leadership Conference also assisted with getting the word out. Through this we drove people to our blog post about the project as well as to the City's Engage Page.

In addition, pavement mural layout designs were shared on Ashley Kyber's Kyber Design Workshop Facebook and Instagram feed. This audience, mostly of art and design professionals both local and nationwide, also yielded high viewing and audience support.

Jan Raether, Infrastructure Engagement Specialist, Office of the Mayor, has been helping along the way with community outreach from the City end. He facilitated the inclusion of the project on the City's Engage Page as part of DOMI's Trail to Mairdale Project, which already had a level of community outreach completed by DOMI staff. This city-run site became the primary forum for collecting feedback and hosted the online voting.

Finally, the CLP Woods Run Library had a display up inside the building to solicit feedback from their daily patrons. They displayed the three

	<p>alternatives with a way to vote and leave comments. Through this process, we settled on the final design.</p> <p>We feel that the level of community engagement is high for a project of this size.</p> <p>July 2023: We presented the initial draft design (attached here) at the South Side Slopes Neighborhood Association annual picnic with over 75 attendees seeing the design. We also shared the design online on our Facebook, e-blast, and website to get more feedback. We have continued to request and take feedback from the community via social media.</p> <p>September 2023: Online RCO meeting with an updated design given feedback</p> <p>December 2023: Shared the updated design with 100+ South Side Slopes neighbors and friends at our annual Holiday Party</p> <p>February 2024: Another updated design which we distributed flyers for at the Arlington Recreation Center in addition to sending to the neighbors via e-blast and social media.</p>
<p>What is the timeline of implementation?</p>	<p>We plan to install the mural when the temperatures are consistently warm enough, ideally in May, and should take about two days to complete. We would like to paint the mural while the CAPA students are still in session, as it may be difficult to track them down once school lets out for the summer. We would like to have the project complete for an official unveiling of the mural for the Library's 60th anniversary of their current location in July.</p>
<p>Are there plans for future expansion of this project?</p>	<p>No.</p>
<p>What is the budget for this project, and what are the funding sources?</p>	<p>AARP provided the funding for the project. We are anticipating it to cost up to \$12K, which includes artist services, materials, supplies, snacks for the design charrettes, maintenance/removal and supplies for the unveiling. Over the past decade, AARP has been funding small, traffic calming interventions and street murals across the country as they are proven ways to make it safer to walk and bike.</p>
<p>Who will be responsible for maintenance of this project, and are there dedicated sources of funding for maintenance?</p>	<p>Bike Pittsburgh is 3,000+ member bicycle and pedestrian advocacy organization who has been working in the Pittsburgh urban core for over 22 years. Our work involves partnering with key stakeholders (such as the City of Pittsburgh) on projects in the public realm, as well as hosting four major public events per year, ie. three OpenStreetsPGH events and PedalPGH, Pennsylvania's largest organized bike ride. We are a 501c3 non-profit with a \$1.5M budget and are able to cover the costs or fundraise as needed to either remove, touch up, or paint over the mural if need be. The durable epoxy paint will need very little maintenance in the short term, and we will be able to cover any maintenance costs within our existing budget, as well as reserve from the AARP grant itself.</p> <p>Copies of our annual reports can be found on our website: bikepgh.org/about-us/</p>

	<p>We are currently working on the required Ownership and Maintenance Agreement as part of the Department of Mobility and Infrastructure’s permit requirements, which will ultimately need City Council approval. We are working on a draft agreement (which is based off of the previously approved street mural in Bloomfield) that DOMI and DCP are actively reviewing. In short, BikePGH is on the hook for the maintenance of the artwork. However, as this is supplementing a DOMI project, DOMI will be responsible for the surrounding flexpost bollards and painted outlines that are already in place.</p> <p>Our plan is to use a durable epoxy paint that, according to the company’s spec, should last between 5-7 years in extreme heavy duty traffic areas. However, as the area will not have cars driving over it, nor will it be getting plowed, salted, or street swept, we are confident that it will last even longer. With that said, through our relationship with CLP Woods Run, we expect to have their “eyes on the street” to alert us if there are any issues with the mural that need attention. We plan to revisit the mural annually to inspect its condition and provide any necessary touch ups. After 3 years we will inspect the mural and determine if it needs to be repainted, touched up, removed, or ideally, left alone. If it is determined to be in a quality condition after 3 years, we will ask DOMI for an extension of the mural’s approval. If it is in poor condition, we will have the mural removed appropriately, likely through power washing or covering it up. As it’s a small enough area, we don’t anticipate the cost of removal to be exorbitant, and have budgeted some of the grant for this. It’s worth noting that as part of our Ownership and Maintenance Agreement with DOMI, they will be able to remove the mural for any reason.</p> <p>Also of note, while no utilities have any planned construction in the area, if for some reason the mural must be removed to access utility assets below the street, we will not be repainting the mural..</p> <p><i>Staff note: As detailed above, applicant will enter into legal agreement with the City of Pittsburgh, per city policy regarding limited-term art. Applicant will be responsible for upkeep of mural. If mural has been maintained after initial approval period, extension may be given. If mural is not in good condition at this time, applicant will be responsible for removal.</i></p>
<p>If the project has an online engagement page, please provide the website address.</p>	<p>https://engage.pittsburghpa.gov/complete-streets/trail-mairdale-neighborway</p>
<p>Please explain any time limitations, budget restrictions, or other conditions that are affecting the scope of this project.</p>	<p>Nothing major comes to mind. I have received confirmation from all of the utilities that they have no plans to dig in the area in the next 1-3 years.</p>
<p>Please include any additional information necessary for project review.</p>	<p>Of note is the materiality of the pavement paint, COLORSAFE Epoxy by Transpro Industries has been chosen for long-term durability 5-7yrs in extreme heavy duty traffic areas and up to 10 yr (according to the company’s spec).</p>

	<p>Although this material was chosen for durability, it cannot be used by non-professionals in citizen engagement.</p> <p>Link to the website is here: https://transpo.com/products/pavement-marking/unique-applications/</p> <p>This product is specified for pavement murals and is one of the highest quality materials of its kind due to its long term durability. Given the citizens, Carnegie Libraries and BikePGH have made a large investment in citizen capital, durability is a prime concern. However, DOMI’s maintenance agreement will require us to revisit the site every three years to assess wear and to determine if the mural will need to be touched up, left alone, or removed. The asphalt itself on Woods Run was freshly paved in 2023, but will not be repainted by us after future resurfacing.</p> <p>DOMI staff, Paige Anderson and Katie Wettick, have given us approval to use this product.</p>
Letters of support	Marshall-Shadeland aka Brightwood Civic Group, City of Pittsburgh Department of Mobility and Infrastructure, additional letters forthcoming

Commissioner comments and questions from Preliminary Review, January 2024:

Commissioner Comments
<p>The updated materials for this project proved helpful and answered the questions I had in a previous review for the project. Other than looking forward to seeing the imagery for the mural itself, I have no additional practical/logistical questions.</p>
<p>1. Two different durability ratings for the pavement epoxy paint are shared in your proposal: 10-20 years (summary of project) and 3-5 years (maintenance). Could you please share with us which one is the accurate figure?</p> <p>2. In the current mural design, there are no bikers with dark skin notes included. Could this please be updated to include more diverse representation in the artwork, so that no community members are excluded in the design? Please also include diverse hair styles as well, not just straight hair.</p> <p>3. I see that quite a bit of stock imagery was used in the draft mural design, including watermarks still left from stock footage sites. To give us an idea of the artist's ability to execute the design as a painted mural rather than digital collage, could you please include samples of their previous painted mural work so that we can ascertain feasibility?</p>
<p>What is the length of time for the installation? Apart from paint – what is the hope for how long it will remain? 10-20 year installation is long. Mention of 3-5 years in proposal. Seems answer is 3-6 years, correct? How was CAPA selected as those to implement? Were other artists offered opportunity? Good to know “three neighborhood students are in the group working on the project.”</p> <p>AARP grant was already approved. For \$12k – total amount of the project? Seems like it was a bit of cart before the horse.</p> <p>How were buildings to be included be selected for the design? Some information – but not full understanding. Through three sessions?</p> <p>Is there date on calming projects also be distracting projects? Concerned about safety for other reasons aside from speeding.</p> <p>Community is called on, there is clearly interest, but at what point do you feel you have enough input? What is the measure of significant input? 3, 5, 25 people?</p> <p>In addition to inviting people to come, how are organizers going in community to ask/engage?</p> <p>Design is nice enough – and it is good to see some engagement – but again, feels limited. In times like these, is this sufficient? Impactful? Necessary? Could colors do the same thing?</p>

Supplemental Materials Document for Art Commission Preliminary Review

Woods Run Street Mural Asphalt Art

Prepared 4/3/24 by Eric Boerer, BikePGH and street mural project manager

We are excited to present to the Public Art Commission the work we've done toward creating a street mural to improve the safety and beauty of Woods Run Ave, in front of the Carnegie Library of Pittsburgh, Woods Run Branch.



Existing Conditions

View of proposed area exiting the CLP Woods Run Library Front door. The area to be painted is the triangle shaped area that DOMI already marked and added flexposts to, rendering the area free from motor vehicles. It's now just a large area of asphalt.



Engineering

Engineering documents prepared by Paige Anderson, Department of Mobility and Infrastructure. Paige prepared these documents to assist with the development of the “artistic bumpout” as part of their Trail to Mairdale traffic calming project.

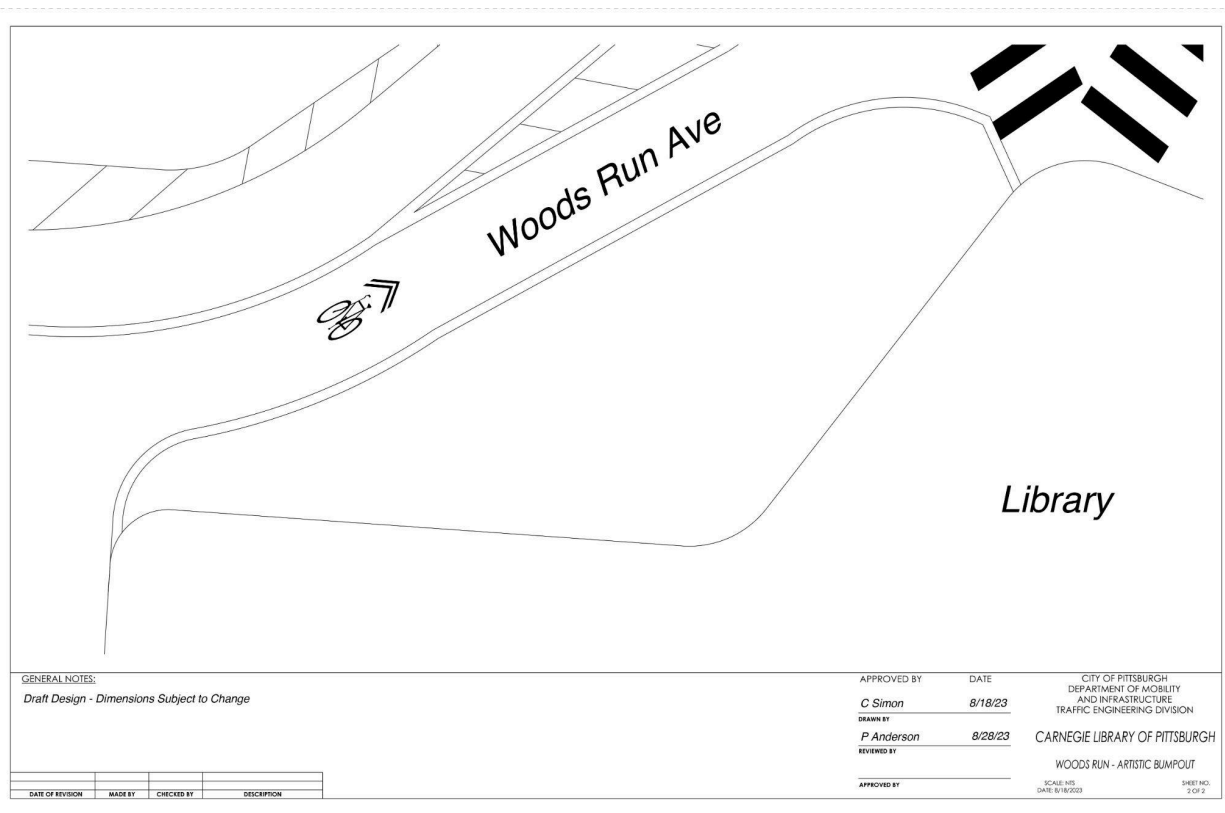
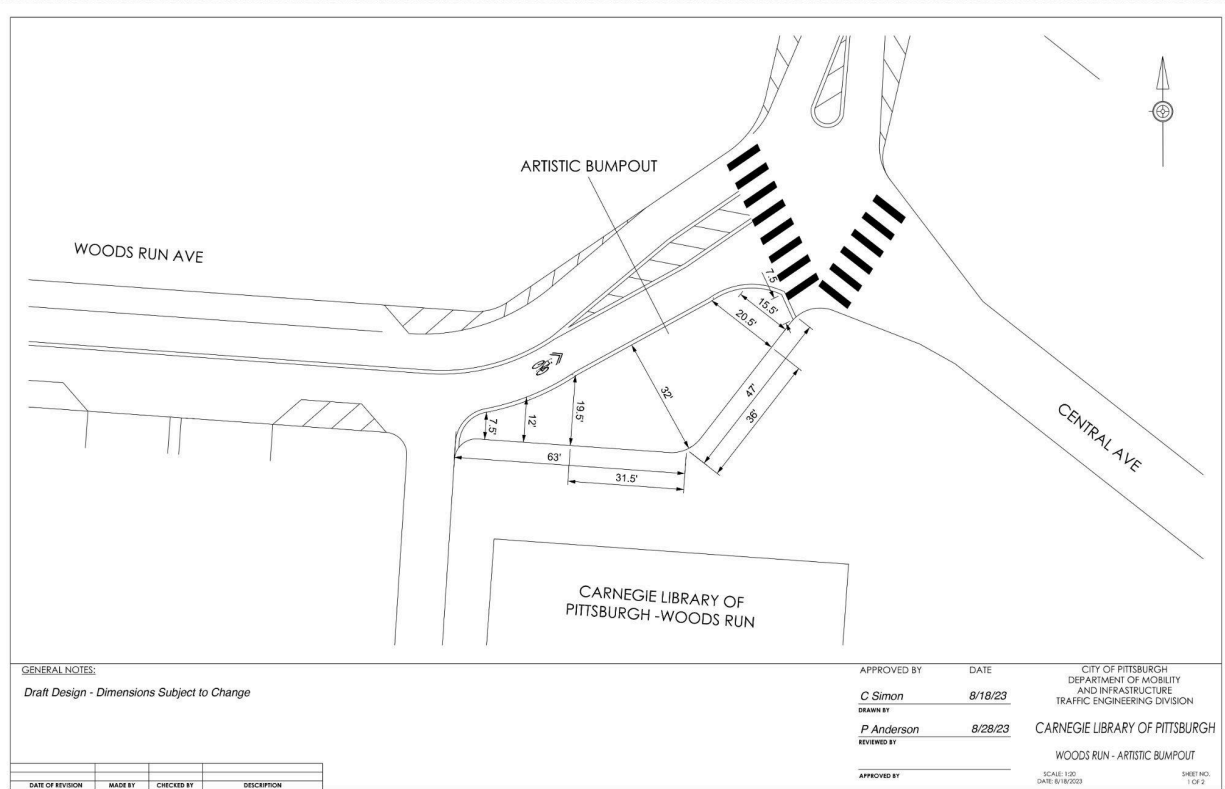

Location

A map of the overall Trail to Mairdale project scope. The mural will be painted on the curvy section of road near Central Ave, shown at the red star.

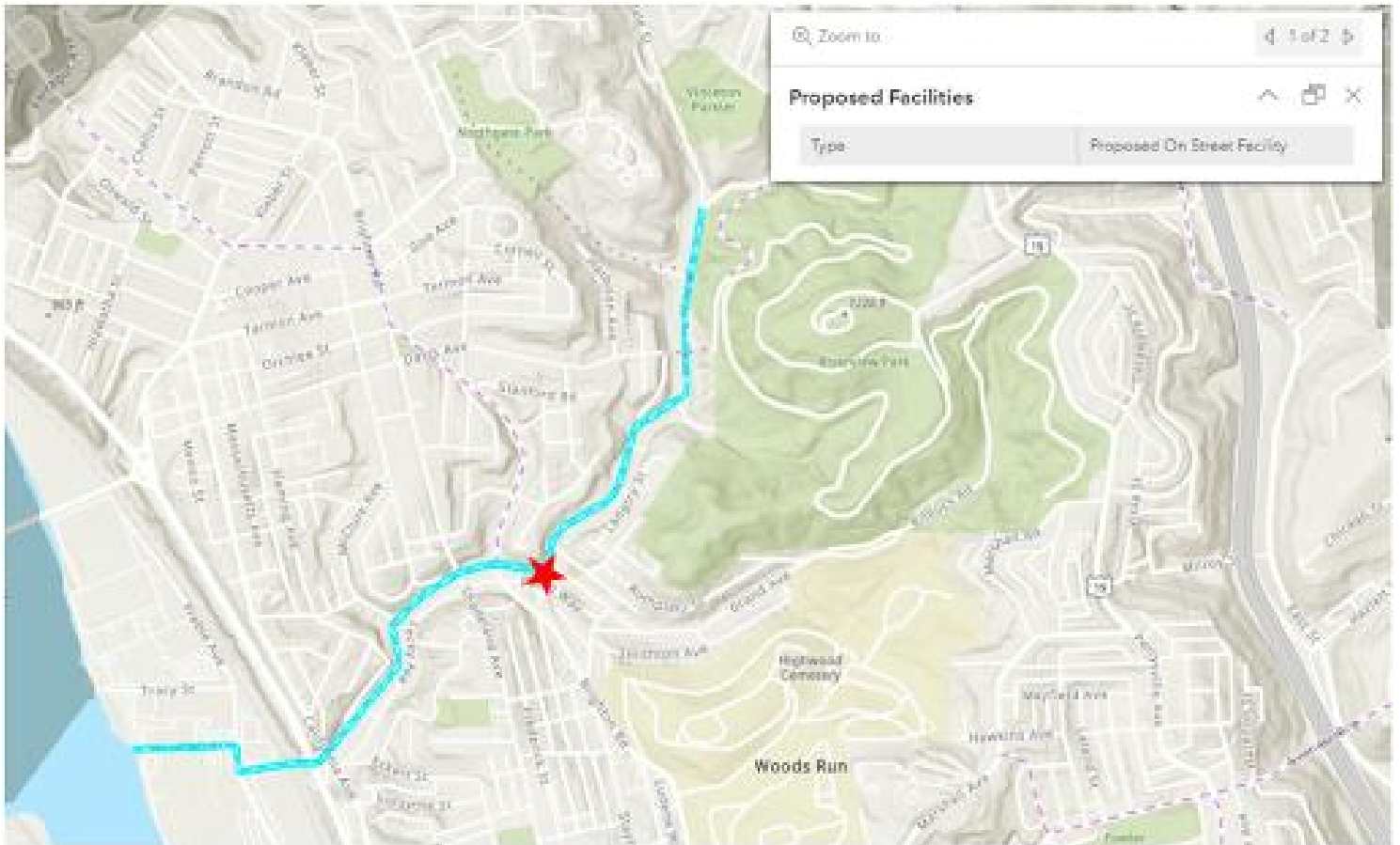

Project extents highlighted in light blue.

Artist Ashley Kyber



I am a passionate creative visionary with enterprise in the fields of landscape architecture, public art and food-systems design. I spent the first twenty years of my career as a university professor in the land-grant university system focused on outreach and engagement leading citizen-driven community development processes in the public realm.

I am a mid-career professional dedicated to social and environmental justice issues working to build pedagogies of engagement to empower community groups, individuals and non-profits to develop sustainable solutions to climate change.

Experience and Awards

Winner of The World Studio Foundation's Honda Environmental Design Award, Tulsa Living Arts Warhol Prize and public art commissions by Park Pride Atlanta and St. Louis Transit Authority, I have led a critical practice of social engagement as an artist and landscape architect. Not only do I build landscape spaces that reflect ecological, social and spiritual histories of place. I make places that aspire to feed people, mitigate stormwater and provide educational and workforce training opportunities.

Cyberkyber Design Workshop

Kyber Design Workshop is Ashley Kyber's creative enterprise featuring artwork and public art proposals. This private practice draws on principles of permaculture and landscape architecture to create community-based landscape interventions that engage creative solutions to climate change. Focusing on the public realm, I am a co-creative partner with nonprofits, citizen groups and individuals investing in systems-change models that value resiliency, the local and the sustainable.

Instagram: [@Artashley_dsn](#)

Linkedin: [ashley-kyber-38252328](#)

Facebook: [facebook.com/cyberkyber/](#)

Ashley Kyber's Previous Relevant Work

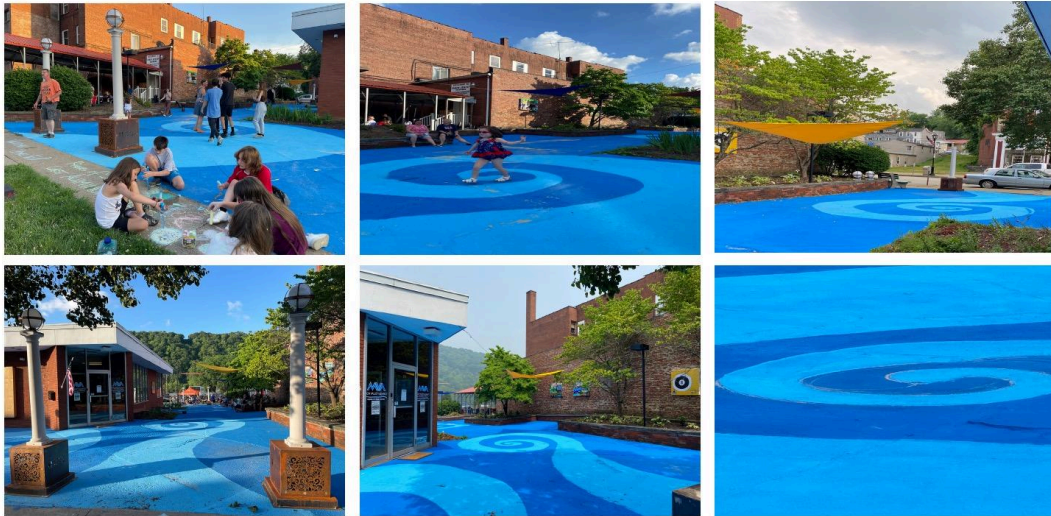

MonValley Alliance RiverCurrents Pocket Park
 Monongahela, PA
 In Partnership with Main Street Monongahela and The Monongahela Chamber of Commerce
 A Community-Built Space

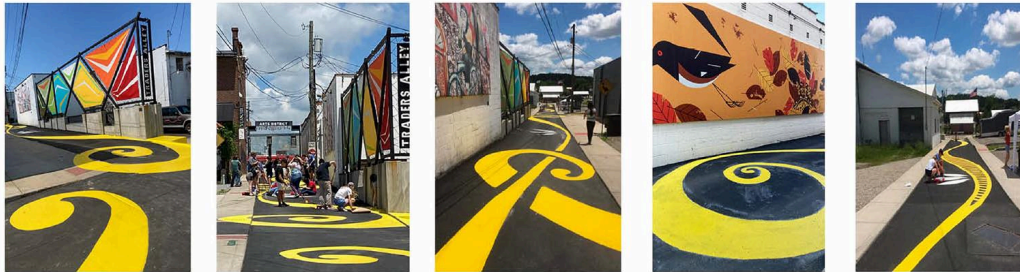

VIDEO LINK: https://www.youtube.com/watch?v=_A6J8ZA3pfo

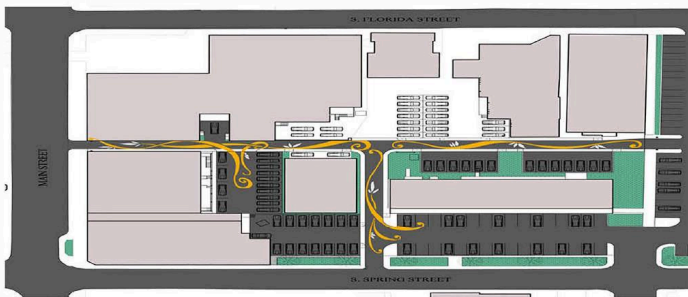

StreetArt @ Trader's Alley
 -a Community-Built Space In Partnership with ART26201-
 Artists Bryson VanNostrand and Ashley Kyber

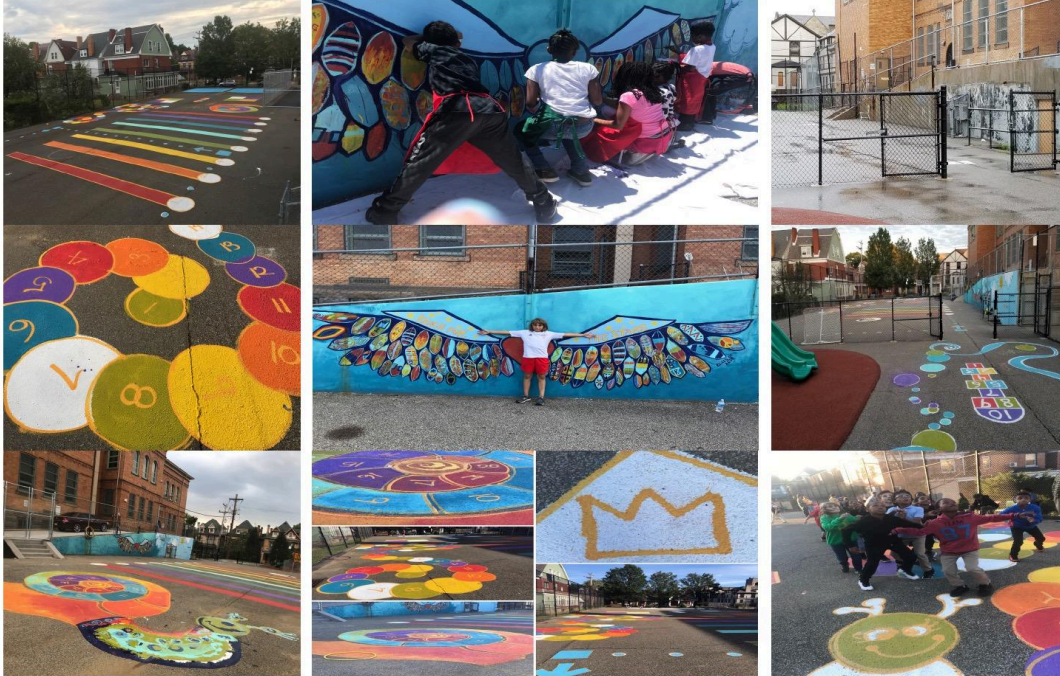

Fulton Elementary School Playground Murals

Pittsburgh, PA

In Partnership with Pittsburgh Public Schools and KABOOM 2019
(Before and After Photos Top Right)

Video Link: https://www.youtube.com/watch?v=fYtAgl0e3_s&t=21s



Confluence Cycery Murals

on the Great Allegheny Passage in Confluence, PA

Confluence Creative Arts Center ECOart Camp 2021

Camp and Mural Funded by Artist by Grant from The Community Foundation of the Alleghenies

Community Outreach and Engagement



COME JOIN US! DESIGN A STREET MURAL FOR CLP-WOODS RUN LIBRARY

Woods Run Street Mural Planning Sessions:

Location: CLP Woods Run

1201 Woods Run Ave, Pittsburgh, PA 15212

Join the artist Ashley Kyber, BikePGH, and the Woods Run Carnegie Library at any of the following hands-on brainstorming sessions. We will design the street painting mural together with YOU!

All ages are welcome!

Sat Oct 21	2-4PM	Unveiling of Design TBD
Thurs Nov 9	5:30-7:30PM	Paint with us next SPRING!
Sat Dec 2	2-4PM	



Engagement

A photo of the first community engagement session on Saturday, October 21 2023 at the CLP Woods Run Library. Present are the branch manager and the artist.



A photo from the third community engagement session on Saturday, December 2, 2023 at the CLP Woods Run Library.



Online Voting

Working with Neighborhood Services in the Mayor's office, we put three concepts up for a vote on the City's Engage Page.







Concept A and B are similarly themed, but with a different composition. Concept C is a totally different theme.

After online voting closed on March 29, with about 20 participants, Concept B received about half of the votes, with the other two concepts evenly splitting the rest, giving us a fairly good sense to move forward with Concept B.

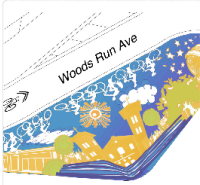
Here is a screenshot of the Engage Page voting. Each concept could be expanded to view the details.

Which concept do you prefer?

Rank your favorite design by dragging images to the right. Click images to enlarge.

	<p>Concept A Concept A</p>	
	<p>Concept B Concept B</p>	
	<p>Concept C Concept C</p>	

Leave a comment

Artist Concept and Final Design

A three staged hands-on process was developed to allow residents a means for public engagement. This robust process allowed for neighborhood citizen engagement involving residents, library patrons, students and community groups via three design workshop sessions held on-site at the library with lead designer Ashley Kyber and two teaching artists.

The goal of these sessions was to flesh-out the visual elements that citizens would like to see represented in the final design and to guide the second stage of the design process. Once the citizens developed the design ideas and content, the project was passed to students at Pittsburgh Public School's CAPA visual arts department under the leadership of Tom Higgs for the second stage of the process. Three neighborhood students are in the group working on the project.

Ideations from the initial design engagements held at the library were polished into final design layouts on the site plan, and generated three options that were passed back to the community for input via the third and final engagement component hosted on the City's Engage Page and inside the library itself. Residents were able to rank their favorite designs and provide feedback. The outcome of this online voting process revealed that one concept garnered about half of the votes, while the other two evenly split the other half, giving the team an assurance that we should move forward with the winning concept.

<https://engage.pittsburghpa.gov/complete-streets/trail-mairdale-neighborway>

Some things of note:

- The unique building in the middle (emerging from the book) is St Leo's Church, long an important pillar of the Woods Run community. The church is no longer there, but we heard how important it was to residents so we wanted to incorporate and honor it in the design
- The building on the left is the original Carnegie Library of Woods Run, located on Brighton Rd and now a daycare center
- The building on the right is the Observatory in Riverview Park
- There is a day to night theme
- Residents expressed interest in highlighting the natural environment of the neighborhood. A "grandmother" tree is an element to denote large old growth trees in the park and an overall wooded/park setting
- The mural also has a bit of a mapping and wayfinding element to it. If you emerge from the library, to the right would be Riverview Park, and to the left would be the river (shown at the far left of the design)



GENERAL NOTES:
 Draft Design - Dimensions Subject to Change

DATE OF REVISION	MADE BY	CHECKED BY	DESCRIPTION

APPROVED BY	DATE	CITY OF PITTSBURGH
C Simon	8/18/23	DEPARTMENT OF MOBILITY AND INFRASTRUCTURE
DRAWN BY		TRAFFIC ENGINEERING DIVISION
P Anderson	8/28/23	CARNEGIE LIBRARY OF PITTSBURGH
REVIEWED BY		WOODS RUN - ARTISTIC BUMPOUT
APPROVED BY		SCALE: NIS
		DATE: 8/18/2023
		SHEET NO. 2 OF 2

Library

Woods Run Ave

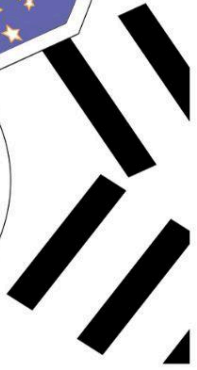

Materials

Of note is the materiality of the pavement paint, COLORSAFE Epoxy by Transpro Industries has been chosen for long-term durability 5-7yrs in extreme heavy duty traffic areas and up to 10 yr (according to the company's spec).

Link to the website is here: <https://transpo.com/products/pavement-marking/unique-applications/>

This product is specified for pavement murals and is one of the highest quality materials of its kind due to its long term durability. Given the citizens, Carnegie Libraries and BikePGH have made a large investment in citizen capital, durability is a prime concern. However, DOMI's maintenance agreement will require us to revisit the site every three years to assess wear and to determine if the mural will need to be touched up, left alone, or removed.

The asphalt itself on Woods Run was freshly paved in 2023, but will not be repainted by us after future resurfacing.

Although this material was chosen for durability, it cannot be used by non-professionals.

DOMI staff, Paige Anderson and Katie Wettick, have given us approval to use this product.



TRANSPRO
INDUSTRIES

Transpo Industries manufactures a variety of innovative products and materials designed for improving road safety and infrastructure preservation. The company's reputation as an expert in rehabilitation, preservation, and safety has made Transpo a leading supplier since 1968.

WWW.TRANSPRO.COM

Color-Safe[®]
PAVEMENT MARKING

Development Activities Meeting

On Monday, March 25, 2024 the Department of City Planning (DCP) held a joint Development Activities Meeting for the project. As Woods Run Ave is the line between the community groups, and Council Districts, they determined it would be best to host both RCOs in the meeting: Brighton Heights Citizens Federation and the Brightwood Civic Group. A recording of the meeting is available on the DCP website. Attached is also the DCP report from the meeting



Development Activities Meeting

WHAT

The Brighton Heights Citizens Federation (BHCF) and Brightwood Civic Group (BCG) are hosting a Development Activities Meeting in collaboration with the Department of City Planning (DCP) surrounding the proposed CLP Woods Run Library Mural to engage with the communities and address any concerns.

WHO

BikePGH is proposing a Street Mural on Woods Run Avenue, collaborating with the CLP Woods Run Library, DOMI and artist Ashley Kyber. Details can be found at the [project page on BikePGH's website](#).

WHY

Registered Community Organizations receive and relay to the communities the notice of proposed development in the neighborhood. These meetings provide both the communities and the applicant with an opportunity to engage in a meaningful way and raise questions and concerns.

What is a Registered Community Organization?

Community organizations help residents and businesses obtain and share information and establish a network to help improve the quality of life in neighborhoods. Community organizations can become Registered Community Organizations through the Department of City Planning to provide community input on development activities and planning processes. The program also outlines responsibilities and procedures that the organizations must adhere to prior to public hearings.

What is a Development Activities Meeting?

A Development Activities Meeting provides an opportunity for citizens, property owners, business owners, and stakeholders to learn about the proposals that affect them and to resolve concerns at an early stage of the application process. Meetings must be held at least 30 days prior to the applicant presenting to the Planning Commission, the Zoning Board of Adjustment, the Art Commission, or the Historical Review Commission.

The City aims for universal access to all public events. This event is a virtual meeting. If an ASL interpreter or any other accommodations are necessary, please send requests no later than one week before the meeting to Michelle Walker at michelle.walker@pittsburghpa.gov.

WHEN

Monday, March 25th, 2024 at 6:00 pm

WHERE

Zoom Meeting:

<https://us02web.zoom.us/j/87507125095?pwd=OXRrdm9mNENwZ2xXOGQ0MFZnTHI5dz09>

OR

via Phone at +1 (301) 715 8592 using Webinar ID 875 0712 5095



Transpo Industries manufactures a variety of innovative products and materials designed for improving road safety and infrastructure preservation. The company's reputation as an expert in rehabilitation, preservation, and safety has made Transpo a leading supplier since 1968.

WWW.TRANSPO.COM



Color-Safe® PAVEMENT MARKING

Durable and High Definition Color

Color-Safe® is a Methyl Methacrylate (MMA) based product and is one of the only UV stable material used for color pavement marking. Color-Safe® is typically used for demarcation of bike lanes, pedestrian areas, bus lanes, and other specially designated areas.

The use of different aggregates create skid resistance and wear characteristics per project specifications. Easily applied by hand with squeegees and rollers or with automatic spray equipment, Color-Safe® cures without requiring external heat sources.

Color-Safe® is capable of full cure in a wide range of temperatures, allowing for a longer marking season.



Color-Safe® enhances your safety program with high visibility color and increased service life.



SAFER TRANSPORTATION THROUGH INNOVATION

Color-Safe®

PAVEMENT MARKING

Features and Advantages

- Excellent color retention and durability
- High visibility color increases motorist awareness
- Available in a variety of colors
- Easy application
- Fast cure time (30 min at 70°F)
- Wide application temperature range (40°- 100°F)
- Low life cycle cost
- Ability to adhere to both concrete and asphalt surfaces

Application Process

Prepare Surface: Surfaces receiving Color-Safe® must be thoroughly cleaned and free of all dirt. Contaminates that might interfere with the proper adhesion of the material may be removed by sandblasting or shotblasting.

Mix: Color-Safe® application is typically made up of three components (resin, hardener, and aggregate) that must be mixed thoroughly for uniform curing and performance.

Apply: Color-Safe® is applied by either the mixed resin and aggregate method or the spray/broadcast aggregate method.

Refer to the technical data sheet for application details.

No special equipment is required for installation.

Applications

Transpo's Color-Safe® can be used with different sizes and types of aggregate as an anti-skid surface and/or for demarcation.

- Bus lanes
- Bike lanes and bike boxes
- Pedestrian refuge areas and plazas
- Crosswalks and decorative pavements
- Roundabouts
- Toll lanes
- Airfields



Standard and Custom Colors

Transpo's Color-Safe® has many standard color options below, as well as custom colors available upon request.

- Bike lane green
- Bike lane red
- Traffic yellow
- White
- Handicap blue
- Adobe red
- Toll lane purple
- Orange
- Buff
- Black
- Gray
- Pink



Need more information?

WWW.TRANSPO.COM/PAVEMENTMARKINGS

Contact the materials experts at Transpo to find out more about the various products we offer.

If you need advice on how to install the product, the professionals at Transpo will guide you through the process. Project specific questions? We can assist you in creating a cost-effective, tailored solution for your project.



Transpo Industries, Inc.
20 Jones Street
New Rochelle, NY 10801

914.636.1000
800.321.7870
914.636.1282
info@transpo.com

Phone
Toll Free
Fax

Manufactured By:





April 4, 2024

Commissioners
Public Art & Civic Design Commission
Public Art Committee
100 Ross Street, Suite 202
Pittsburgh, PA 15219

Dear Commissioners,

Carnegie Library of Pittsburgh is pleased to write this letter of support on behalf of BikePGH's application to the City of Pittsburgh Public Art & Civic Design Commission for an installation of a street mural in front of our Woods Run location.

BikePGH has worked with the City of Pittsburgh's Office of the Mayor, Department of Mobility and Infrastructure, and Registered Community Organizations. This public art initiative, in tandem with the infrastructure changes put in place by DOMI this past year, aims to make our streets safer for pedestrians and cyclists, as well as beautify this site used by many residents of the Marshall Shadeland and Brighton Heights communities.

Carnegie Library of Pittsburgh - Woods Run collaborated with BikePGH during the fall of 2023 to conduct a series of community engagement sessions for this initiative. Through these sessions, community members engaged in dialogue with artist Ashley Kyber, BikePGH and library staff, and each other to develop and refine the preliminary mural concepts. We believe the final conceptual renderings reflect valued assets and landmarks that emerged from these sessions, both current and historical.

Again, we are delighted to be a part of this initiative, and eagerly look forward to this welcome addition to our neighborhood landscape.

Sincerely,

Ian Eberhardt
Library Services Manager
Carnegie Library of Pittsburgh Woods Run
1201 Woods Run Ave
Pittsburgh, PA 15212
412.761.3528
eberhardti@carnegielibrary.org

Carnegie Library of Pittsburgh
Woods Run

1201 Woods Run Ave.
Pittsburgh, PA 15212
P 412.761.3730
F 412.761.3445
www.carnegielibrary.org



Marshall- Shadeland Civic Group aka Brightwood

e.brightwoodcivic@gmail.com
p.412.867.9332

04/02/2024

To Whom It May Concern,

The Marshall-Shadeland aka Brightwood Civic Group Board of Directors give our full support to Bike Pittsburgh CLP Woodsrun Library Mural project. We look forward to continuing working with Bike Pittsburgh on improving the quality of our community.

Thank You

A handwritten signature in blue ink that reads 'Angel Gober'. The signature is written in a cursive, flowing style.

Angel Gober
Marshall- Shadeland aka Brightwood Civic Group President

ED GAINEY
MAYOR



KIMBERLY LUCAS
DIRECTOR

CITY OF PITTSBURGH
DEPARTMENT OF MOBILITY & INFRASTRUCTURE
CITY-COUNTY BUILDING

April 1, 2024

Public Art & Civic Design Commission
C/O Department of City Planning
100 Ross Street, Suite 202
Pittsburgh, PA 15219

Dear Public Art & Civic Design Commission:

This letter serves to show DOMI support of the proposed Woods Run mural in front of 1201 Woods Run Ave, the Carnegie Library Woods Run Branch.

The proposed street mural is part of DOMI's "Trail to Mairdale Project." A recently installed project that includes speed tables, improved pedestrian crossings, shared-lane pavement markings, wayfinding signage and other quick-build safety improvements along the corridor.

Studies have found that streets with asphalt art are safer as it helps visibility, encourages slower driving speeds and creates a more walkable space. The proposed Woods Run mural is located in a "bump-out" where DOMI traffic engineers have found it appropriate to bump out the curb to narrow the lane and slow drivers.

I am happy to offer this letter of support for the submitted proposal and look forward to continuing to partner with BikePGH on this and other traffic calming projects.

Sincerely,

Kimberly Lucas
Director

Development Activities Meeting Report (Version: 06/24/2020)

This report created by the Neighborhood Planner and included with staff reports to City Boards and/or Commissions.

Logistics	Stakeholders
Project Name/Address: Street Mural on Woods Run Ave in front of CLP Woods Run Library	Groups Represented (e.g., specific organizations, residents, employees, etc. where this is evident):
Parcel Number(s): N/A (Public Right Of Way)	Applicants (BikePGH and Kyber Design Workshop Artist)
ZDR Application Number: N/A	Brightwood Civic Group
Meeting Location: Virtual [Zoom]	Brighton Heights Citizens Federation
Date: March 25, 2024, Monday	Area stakeholders/residents
Meeting Start Time: 6 pm	ASL Interpreters
Applicant: BikePGH and Kyber Design Workshop	DCP staff
Boards and/or Commissions Request(s):	Mayor's Office of Neighborhood Services
Public Art & Civic Design [PACD] Commission for a Street Mural in the public Right Of Way	Carnegie Library of Pittsburgh
Approx. Number of Attendees: 13	

How did the meeting inform the community about the development project?

Ex: Community engagement to-date, location and history of the site, demolition needs, building footprint and overall square footage, uses and activities (particularly on the ground floor), transportation needs and parking proposed, building materials, design, and other aesthetic elements of the project, community uses, amenities and programs.

Brighton Heights Citizens Federation spoke briefly about their organization and focus. They see the Woods Run Library as an asset to the community, and are in favor of anything that improves that area and library specifically. Brightwood Civic Group also spoke briefly about their organization and wide-ranging support for the Library in all its endeavors.

Both presenters [applicants] introduced themselves and referenced their prior work experience, training, and/or roles. The artist from Kyber Design referenced their prior work with asphalt murals. BikePGH introduced briefly the mission and membership of their organization and advocacy work they do- all of which focus on improving the biking and walking experience in Pittsburgh and organizing community events. Applicant explained what a street mural is and gave an example of a street mural, noting there are three examples in Pittsburgh, showing images of one in Friendship Neighborhood at S. Fairmont St and Roup Ave. Applicant also referenced one in Friendship Park near the hospital in Bloomfield, and one in Downtown. Showed an image of crash site locations along Woods Run corridor and described how DOMI's project is intended to slow cars down. Applicant noted how AARP recognizes the problem of car crashes with bicyclists and pedestrians is rising, and their dedication of small grants across the country to do small-scale interventions. Received a small grant from AARP of about \$10,000. Showed street view image of the streetscape in front of Woods Run Library. Wanted to do street mural and DOMI recommended this location in front of Woods Run Library given the crash history in area. Goal of street mural is to beautify the area, slow cars down, and provide a "welcome mat" to library. Other reasons to pursue it were the large number of pedestrians, especially children there, that it's a community hub, and there is support from the library branch.

Showed a photo from community engagement activity and dates of engagement, with a poster, and word cloud. Described engagement process, including doing drawings with youth, info shared by a citizen historian of the area, and more. Sometimes took actual drawings, other times notes from conversations, to help inform the schematic design. Worked with a collaborator from Pittsburgh CAPA, who is a digital media teacher in visual arts department of CAPA and also a resident of Brighton Heights and also a sculptor. Showed several images taken from engagement and design process (a “bike-a-pede” made for twenty people, bicycles built out of books, and natural resources in area). Showed a written narrative of relationship between Pittsburgh CAPA and this project. Intent is to have the CAPA students and this teacher help with the mural.

Have created three conceptual designs. Those are out for a vote now on social media platforms. Once have a vote, will move towards production. It will be an epoxy material applied on street. Cannot paint with citizens given the nature of the material, but instead will use stencils and layers to create the designs, which are very graphic in nature. Somewhat cartoon-style image because with this material cannot mix colors.

Showed the design elements that want to see in mural. Large old growth trees in neighborhood (story-holder in neighborhood), park views, Observatory, historic Carnegie Library at Wood’s Run, and St. Leo’s Church. Showed images of these.

Showed Design Option A visualization and link to Engage Page for where to vote. Book in silhouette opening up, with St. Leo’s Church, grandmother oak, trees and shrubs, Observatory with stars, and then along bicycle lane have series of bicycles with people riding them.

Showed Design Option B visualization and link to Engage Page for where to vote. Also is a composite with same elements as Design Option A, but just placed/organized differently. Slightly different color palette too.

Showed Design Option C – created by a CAPA student, with bikes created from books, where pile of books transitions into becoming bicycles, and at bottom are similar design elements as other designs but smaller. If Design Option C is selected, applicant would take back to design drawing board and give more visual tightness to it.

Showed a slide of examples of pavement murals and murals on walls and work the artist has done in the past in West Virginia and Pennsylvania and Pittsburgh regions, and provided background to each of these, where they were done, and noted that all were envisioned and created with school-aged kids. Noted that there has been degradation over time and impacts when water runs over pavement, and wear due to vehicle traffic tires. Lessons learned have led to decision in this project to use epoxy material, which has 10-year lifespan, solidifies in 10-15 minutes once applied to pavement, and which requires different way of applying to the surface of the site.

Implementation to be done in May led by CAPA teacher, CAPA student crew, bike PGH volunteers, and community residents. Shared a link to City’s Engage page to view there the design options and rank them and provide feedback and comments on them. Provided contact info for BikePGH project manager and Kyber Design Workshop.

Plan to go through Public Art & Civic Design commission process in April – have application in by April 3rd. Engage PGH comment page will be up through end of this week. PACD hearing and action will be April 24th. Trying to do it in April to keep CAPA students engaged, since by May school goes out for summer. That is driving the timeline.

Applicant noted the three prongs of engagement to the project and work with students was part of that. Project will be looking for letter of support from community groups.

Noted that the Carnegie Library has an anniversary too. Artist noted pavement work in Monongahela, PA with same epoxy material and how it’s a bit hard to apply but once it has been applied, the material endures very well. Had experience with Strawberry Way Downtown that used a different material and how it is not lasting.

The project will have a maintenance agreement with City – while material should last a long time, supposed to review it every 3 years to either touch it up or renew it, or remove (if failing). There is a process for removal if needed.

Input and Responses

Questions and Comments from Attendees	Responses from Applicants
<p>. [Carnegie Library rep:] Glad to be a part of this...Thank you for making the connection. We have a lot of neighborhood youth that come to library and senior citizens for learning and engagement tasks and we're excited about this development.</p>	
<p>. [Carnegie Library rep:] 60th anniversary of library residing in current location (as compared to prior location), is July 6th, and so having a community celebration on Saturday July 13th. Hoping to maybe have a public unveiling of this project and also info on the history.</p>	<p>. A party would be great!</p>
<p>. Is that material the same or similar to what DOMI just put down with the bike lanes and stop bars at stop signs? That material is very dangerous when gets wet with rain, and we have a lot of seniors at library.</p> <p>That's good, because otherwise someone could get hurt.</p>	<p>. When we used it with Rivers of Steel in public park, it was a public park space for pedestrians. With the epoxy material we will also add in sand, which makes it a very slip-free surface, and requires a squeegee type application. Often the epoxy is used with gravel/aggregate, but since we don't want gravel to be tripping hazard, in this project we will use sand, which protects it from the slipping hazard.</p> <p>DOMI uses thermoplastic for applications but can't say 100% what using on that DOMI project. Pretty confident it's not exactly the same.</p>
<p>. You mentioned April 3 as your application submission deadline. Do you need the letter of support from us [RCO] before then? Just wondering how to get that to you as our monthly board meeting doesn't happen before that date.</p>	<p>. BikePGH has been in continuous communication with DCP's Public History Art and Design [PHAD] division. We will ask this question and get back to you all asap.</p> <p>[They shared later that day via email as PHAD confirmed that the letters of support will be accepted even after April 3rd, and before the day of PACD hearing i.e. April 24.]</p>
<p><i>[Mayor's Office of Neighborhood Services noted they'd follow up with DOMI to ask about their material and share concerns.]</i></p>	
<p><i>[Discussion of deadline by which a letter of support could be provided to project from RCO]</i></p>	

Other Notes

During and after the presentation, Q/A and other discussions around the Development Activity, the RCOs and the other stakeholders showed their unequivocal support for this project to move forward.

Planner completing report: Thomas Scharff and Nazia Tarannum