



1061 3rd Street  
North Versailles, Pa 15137  
724-327-4431  
[www.pghsignandlighting.com](http://www.pghsignandlighting.com)

September 15, 2020

Re: Encroachment Permit for a Sign

Dear Karina Ricks,

Please accept this letter of request for an Encroachment permit for a CHASE ATM tavern sign to be located at 1607 East Carson Street. Chase has requested that Pittsburgh Sign and Lighting, LLLC install the sign at this location for all customers to be aware of the new location of the ATM.

Please let me know if you have any questions or require additional information.

Sincerely,

Sarah Bradley  
Administrator

WILLIAM PEDUTO  
MAYOR



KARINA RICKS  
DIRECTOR

CITY OF PITTSBURGH  
DEPARTMENT OF MOBILITY & INFRASTRUCTURE  
CITY-COUNTY BUILDING

**Application for an Encroachment on City Dedicated Right-Of-Way**

Date 09/21/2020

Applicant Name Pittsburgh Sign and Lighting, LLC

Property Owner's Name (if different from Applicant) 1700 Partners LLC

Address 1424 N Clayton Street

Phone Number: \_\_\_\_\_ Alternate Phone Number: \_\_\_\_\_

Location of Proposed Encroachment: 1607 E Carson Street

Ward: 17<sup>th</sup> Council District: \_\_\_\_\_ Lot and Block 12-E-294

What is the properties zoning district code? LNC (zoning office 255-2241)

Planning/Zoning Case Number (if applicable) ZDR N/A sign under 4sq ft.

Is the existing right-of-way, a street or a sidewalk? Sidewalk

Width of Existing Right-of-Way (sidewalk or street): 9' (Before encroachment)

Length of Existing Right-of-Way (sidewalk or street): 148' (Before encroachment)

Width of Proposed Encroachment: 2 1/4"

Length of Proposed Encroachment: 3'

Number of feet the proposed object will encroach into the ROW: 3'

Description of encroachment: CHASE ATM double faced non-illuminated tavern sign 2.7sq ft

Reason for application:  
The "CHASE ATM" sign will direct all customers to the location of an ATM machine.



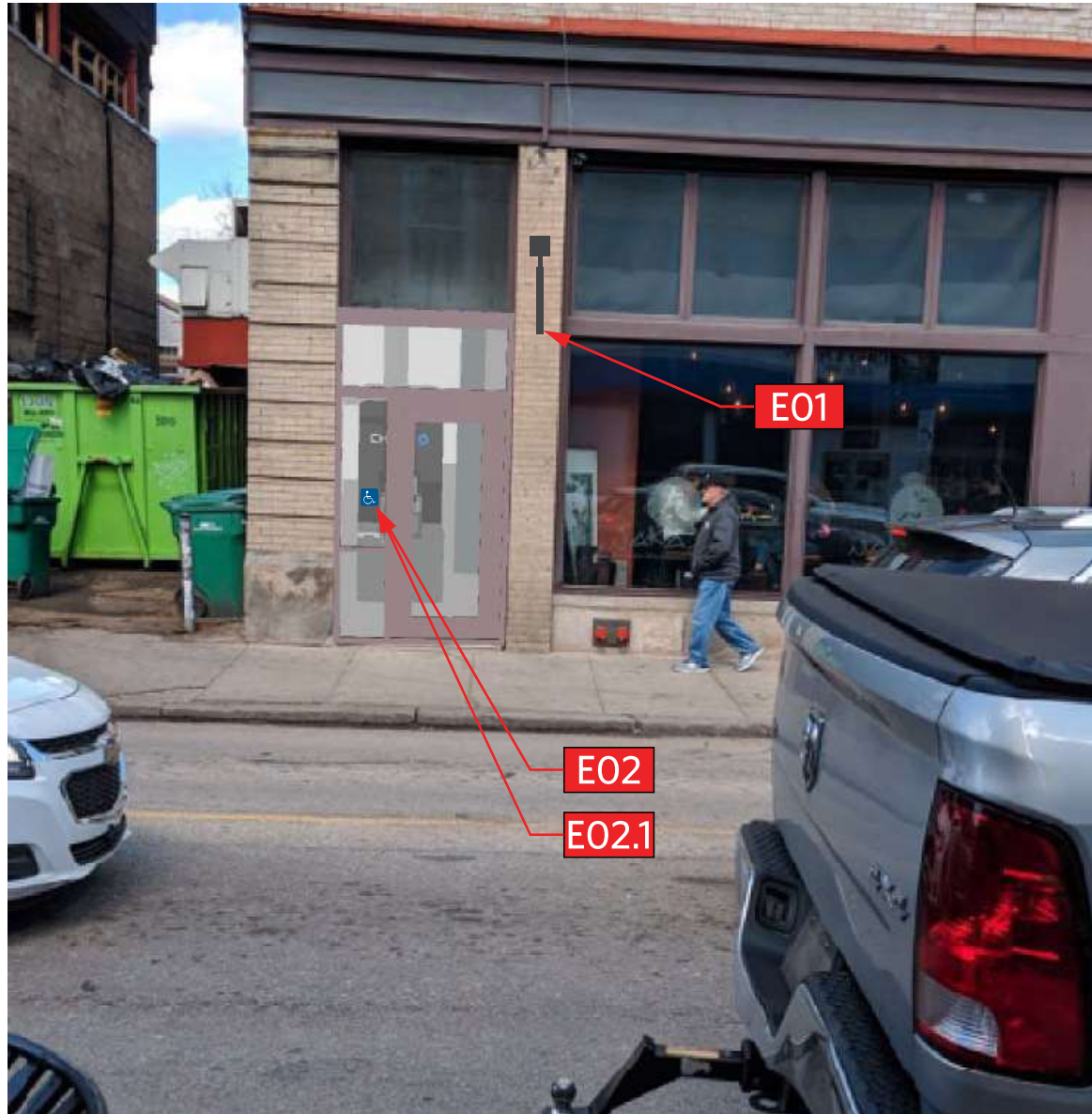

South Elevation

*DIMENSIONS TO BE FIELD VERIFIED*

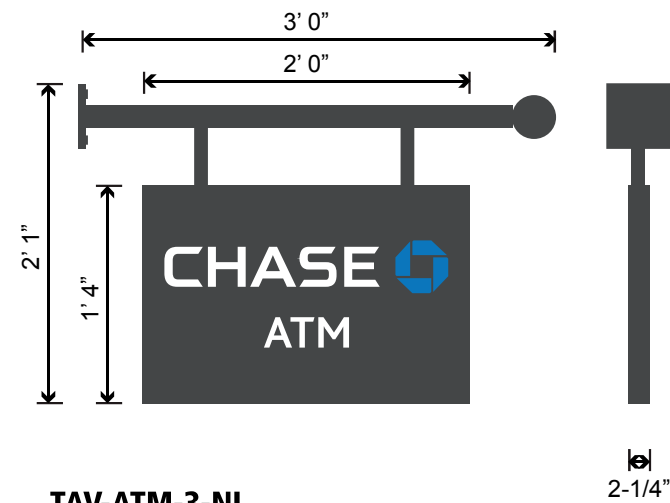

**TAV-ATM-3-NI**  
**DOUBLE-FACED Non-ILLUMINATED ATM TAVERN SIGN - 2.7SF**  
 SCALE: NTS

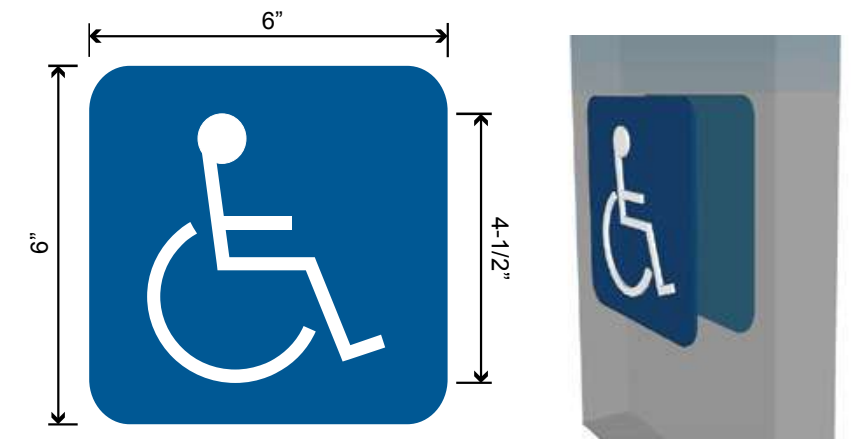

**ADA-EP**  
**HANDICAPPED ENTRANCE PLAQUE**  
 SCALE: NTS

**CUST-VIN**  
**MATCHING BLUE VINYL BACKER**  
 SCALE: NTS

**SIGN E02 MOUNTS  
 BACK-TO-BACK  
 WITH I01.**



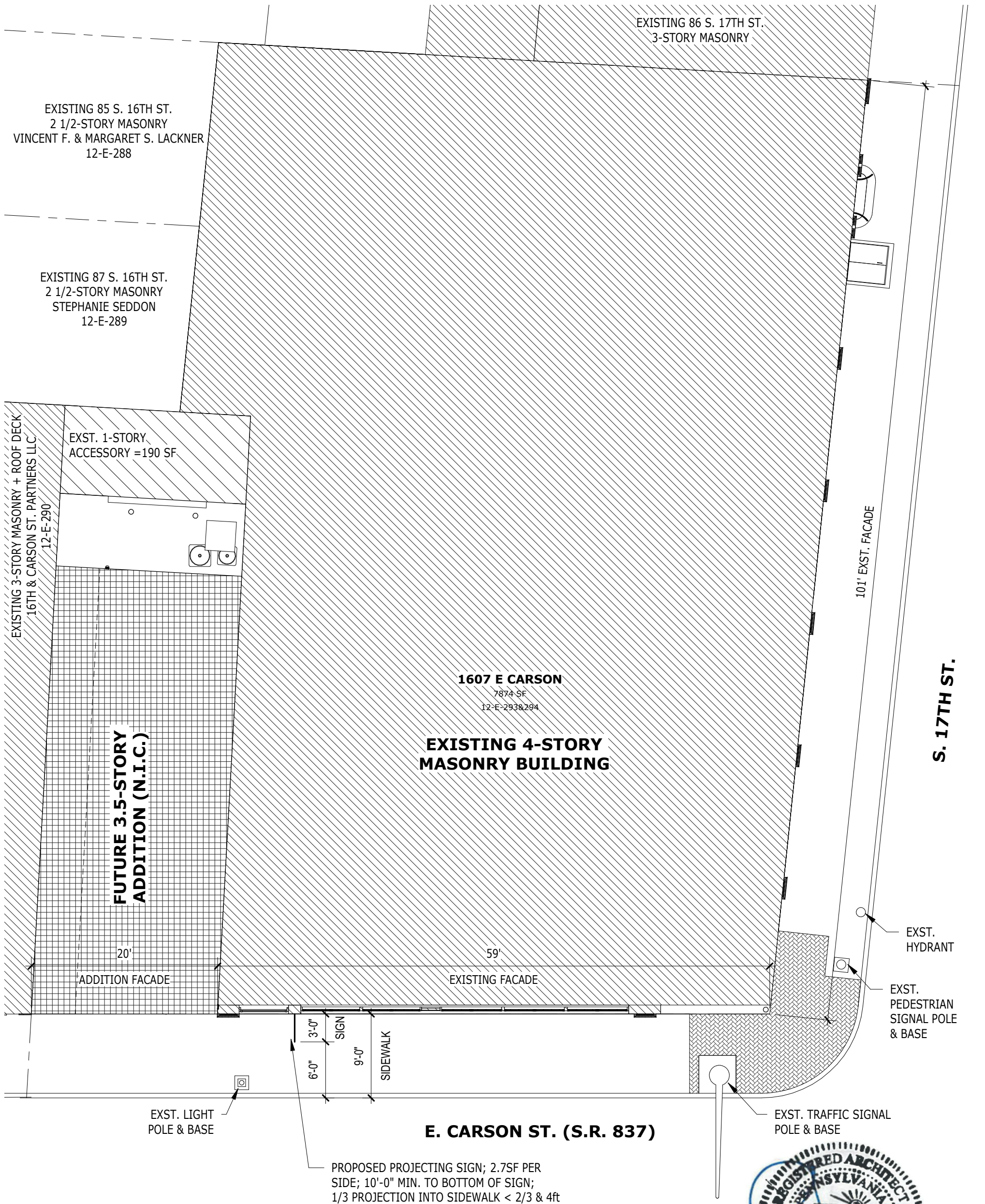

SCALE: 1" = 10'

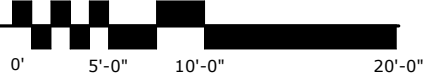

1 **SITE PLAN - SIGNAGE**

S1 SCALE: 1" = 10'-0"

Sheet No.	Title	SIGNAGE SITE PLAN
<b>S1</b>	Project #	17445.2
	Date	08/18/2020
	These drawings are instruments of the Architect's service and are the property of LGA Partners, LP. They shall not be reproduced or used in any way, whatsoever, without the written permission of LGA Partners, LP. 2020	

**THE NAKAMA BUILDING**  
1607 E CARSON ST  
PITTSBURGH PA 15203

**lga PARTNERS**  
1425 Forbes Ave. Suite 400 Pittsburgh, PA 15219  
P 412.243.3430 F 412.224.4747